

**NOTES:**

1. THE LEVELING PAD SHALL BE CONSTRUCTED OF DENSELY GRADED AGGREGATE AND/OR #57 STONE. #57 STONE SHALL MEET THE FOLLOWING GRADATION:

SIEVE SIZE: % PASSING:	
1"	100 - 95
1/2"	100 - 25
No.4	0 - 10
No.8	0 - 5

2. THE CONTRACTOR SHALL HAVE A QUALIFIED GEOTECHNICAL ENGINEER VERIFY THE FOUNDATION SOILS TO ENSURE THAT IT MEETS OR EXCEEDS THE MINIMUM BEARING CAPACITY REQUIREMENTS.
3. THE BASE FOUNDATION SHALL BE APPROVED PRIOR TO PLACEMENT OF THE LEVELING PAD.

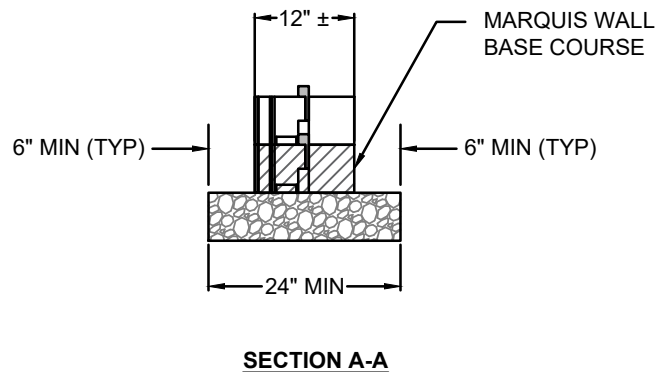
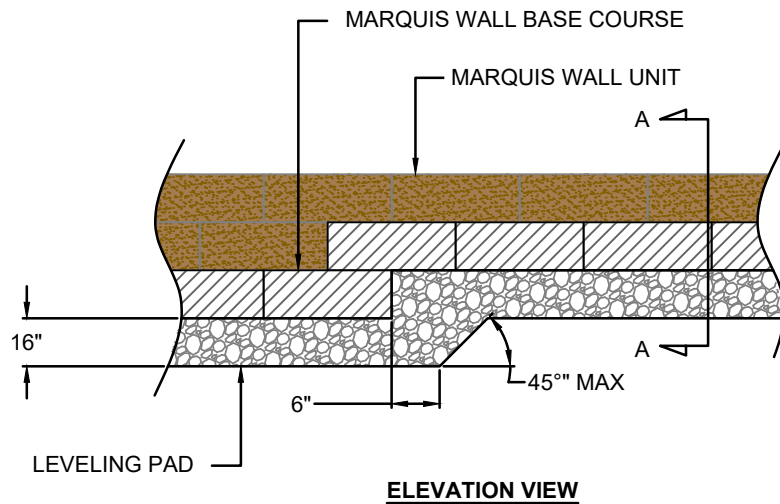

201 Park Ave.  
 Woodbury, NJ 08096  
 (800)-444-3679  
 www.ephenry.com

TITLE:	MARQUIS WALL TYPICAL LEVELING PAD DETAIL
SCALE:	NOT TO SCALE