

# Construction Drawings

## Section 5

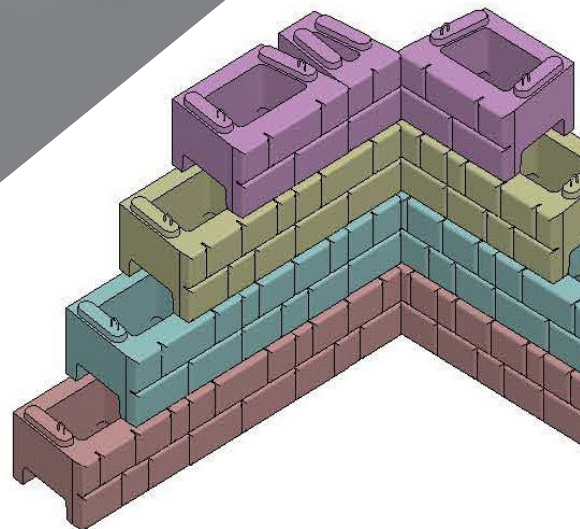

[www.verti-block.com](http://www.verti-block.com)



## TYPICAL GRAVITY WALL WITH 36" VERTI-BLOCK

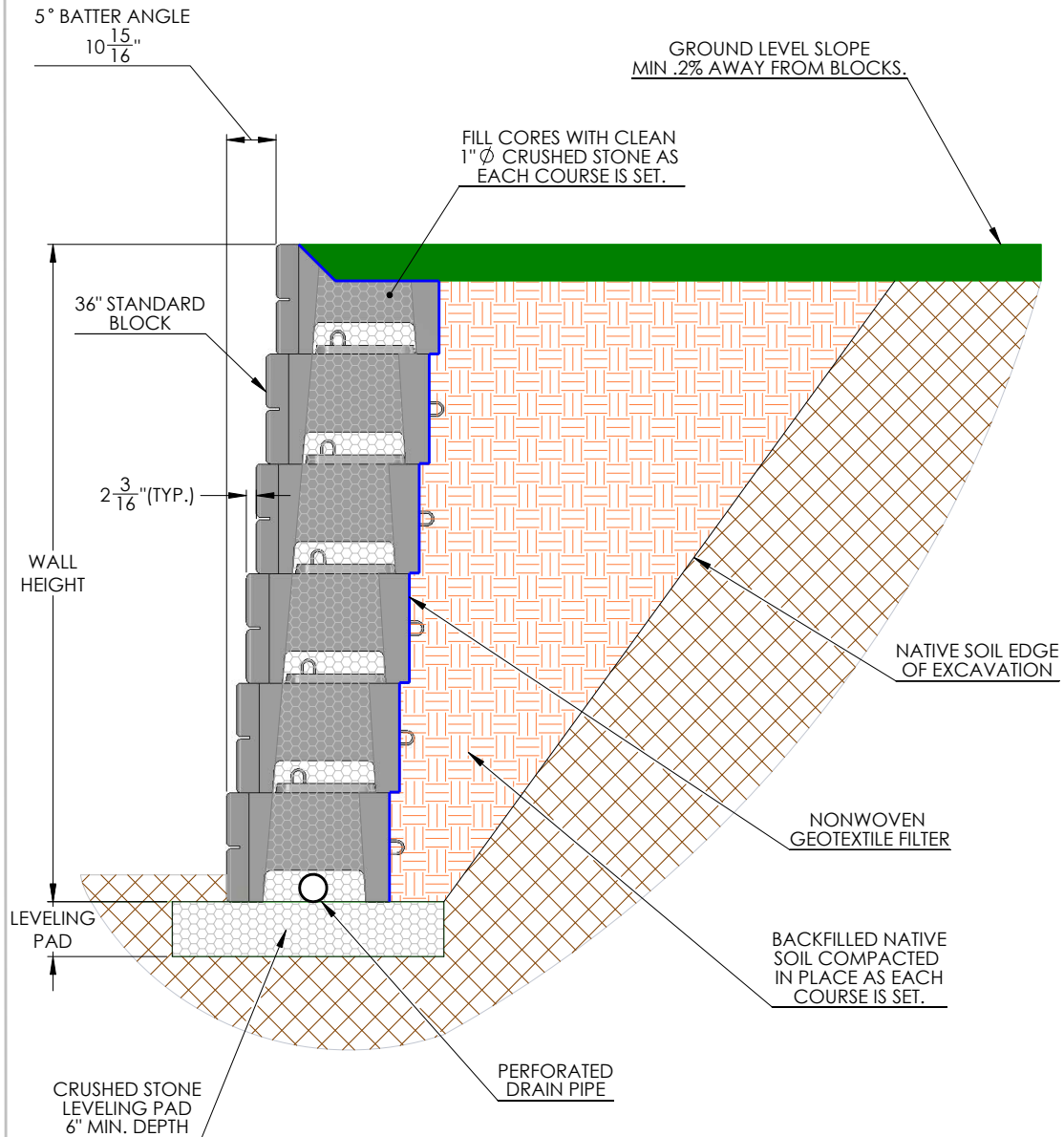

DRAWN BY	DATE	TITLE:
DAN BALLING	12/30/2013	12' RETAINING SECTION
16500 SOUTH 500 WEST BLUFFDALE, UTAH 84065 PHONE: (801) 571-2028		DWG NO.
		WD-14
SCALE: 1: 30		SHEET 1 OF 1

## TYPICAL GRAVITY WALL WITH VERTI-BLOCK MASS EXTENDERS

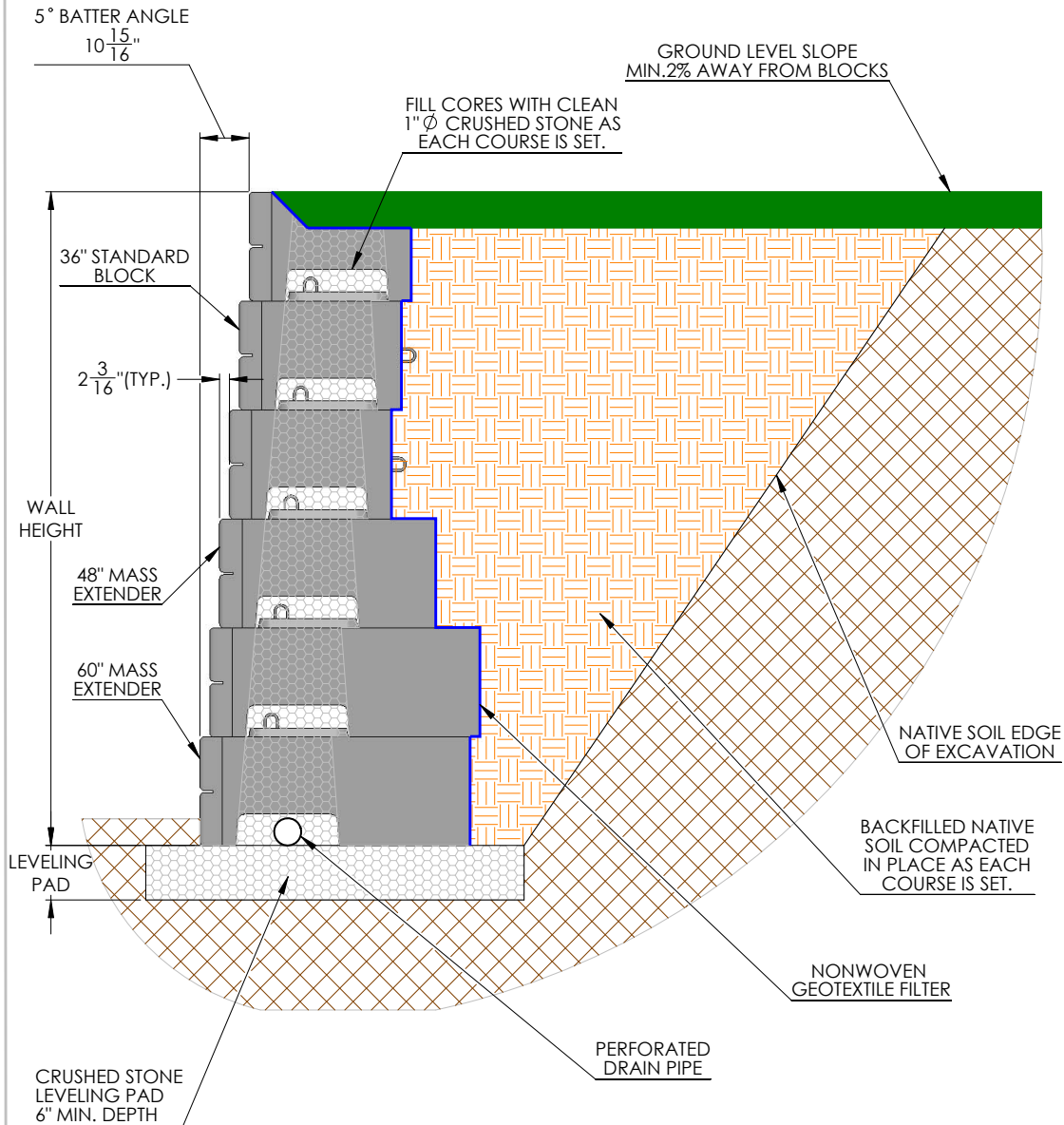

DRAWN BY	DATE	TITLE:
DAN BALLING	12/30/2013	12' SECTION W/ MASS EXTENDERS
16500 SOUTH 500 WEST BLUFFDALE, UTAH 84065 PHONE: (801) 571-2028		DWG NO.
		WD-15
SCALE: 1: 30		SHEET 1 OF 1

## 20' GEOGRID FRICTION CONNECTION

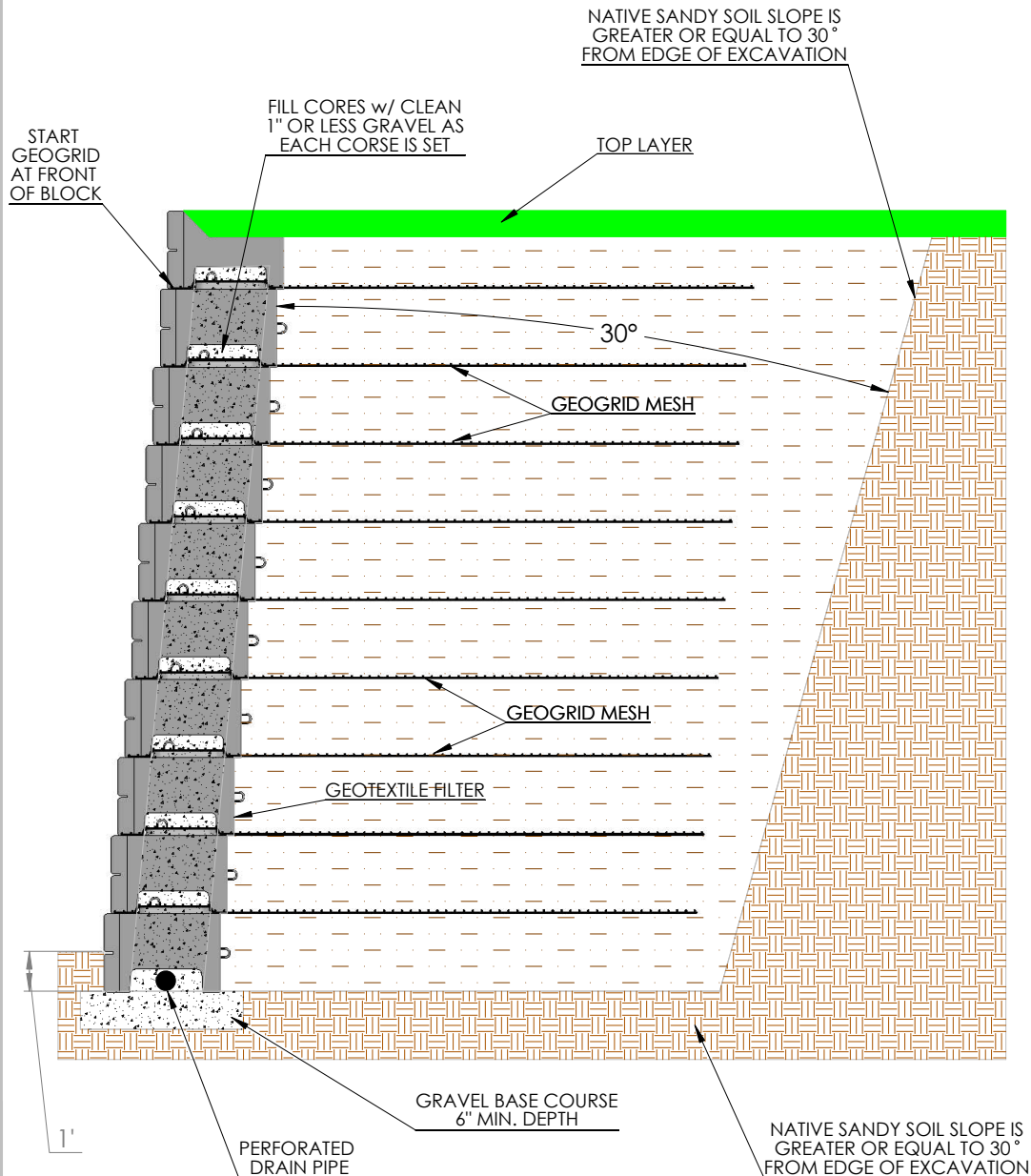

DRAWN BY	DATE
DAN BALLING	12/12/2013
16500 SOUTH 500 WEST BLUFFDALE, UTAH 84065 PHONE: (801) 571-2028	

TITLE: 20' FRICTION DETAIL

DWG NO.

M-03

SCALE: 1: 42

SHEET 1 OF 1



## 20' GEOGRID POSITIVE CONNECTION

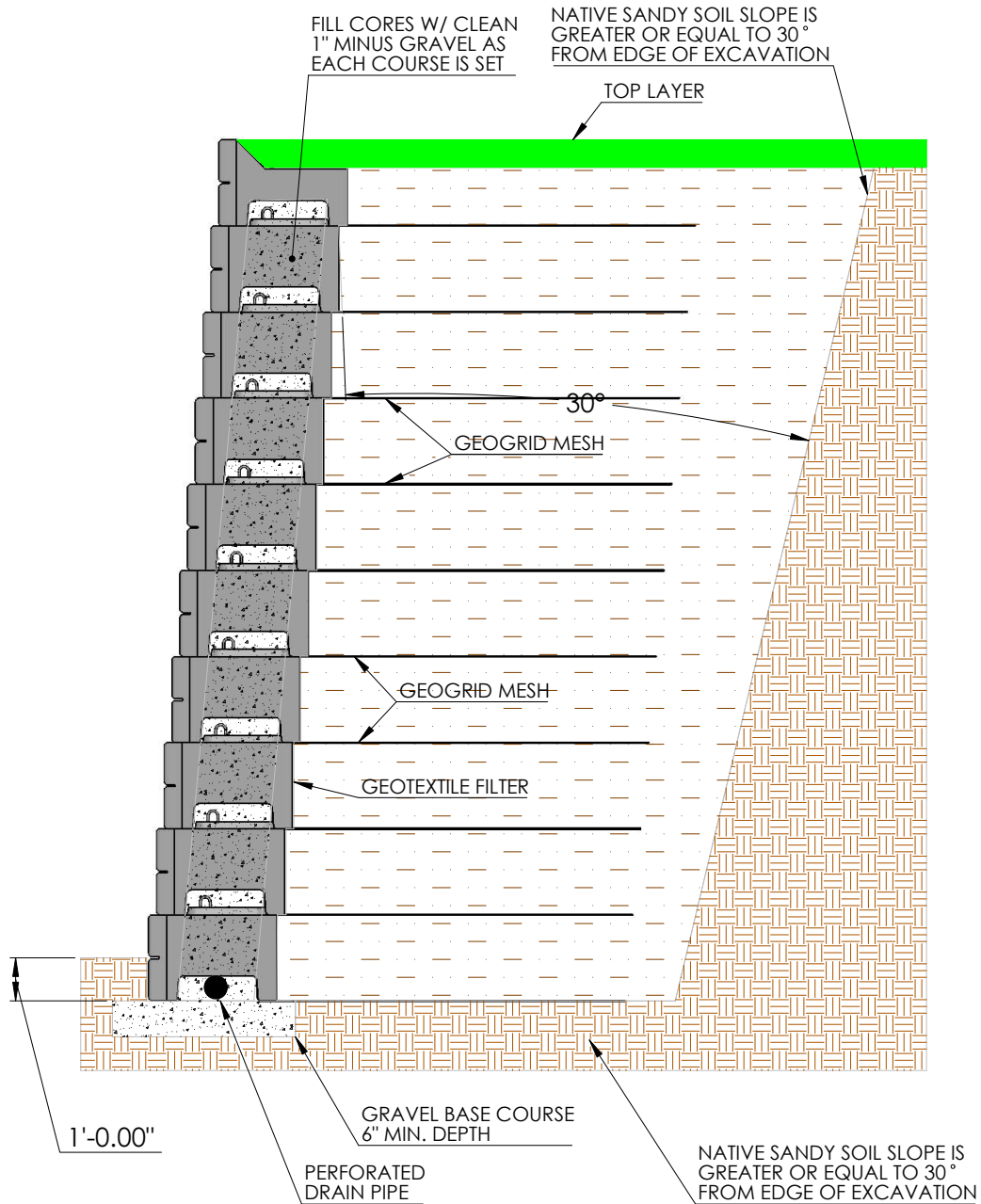

DRAWN BY	DATE	TITLE
R FONTANESI	3/8/2016	20' LOOP THRU POSITIVE CONNECTION
16500 SOUTH 500 WEST BLUFFDALE, UTAH 84065 PHONE: (801) 571-2028		DWG NO.
		WD-36
SCALE: 1:30		SHEET 1 OF 1

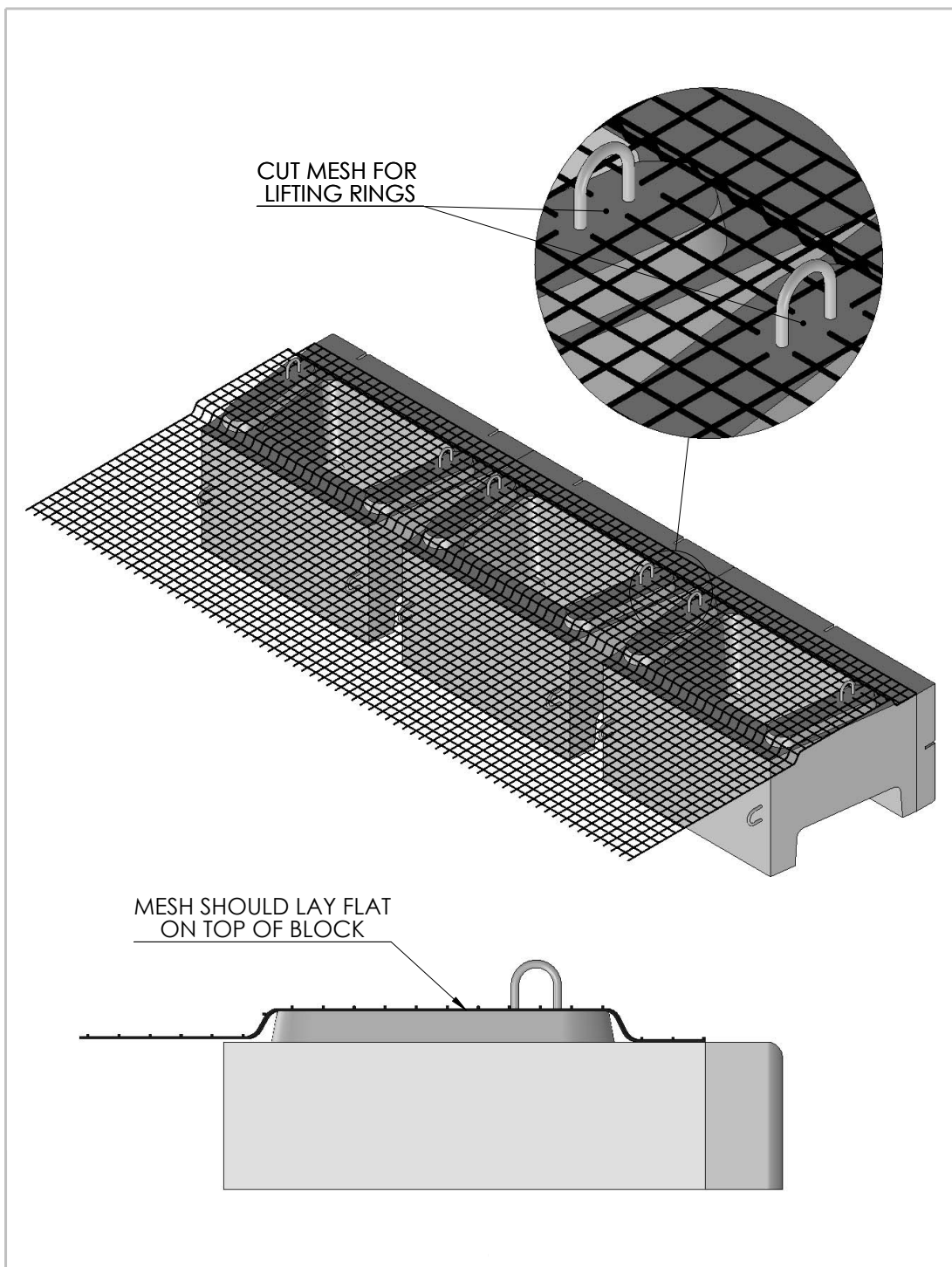

DRAWN BY	DATE
DAN BALLING	12/12/2013
16500 SOUTH 500 WEST BLUFFDALE, UTAH 84065 PHONE: (801) 571-2028	

TITLE:	FRICTION CONNECTION M-01
DWG NO.	
SCALE: 1: 7	SHEET 1 OF 1

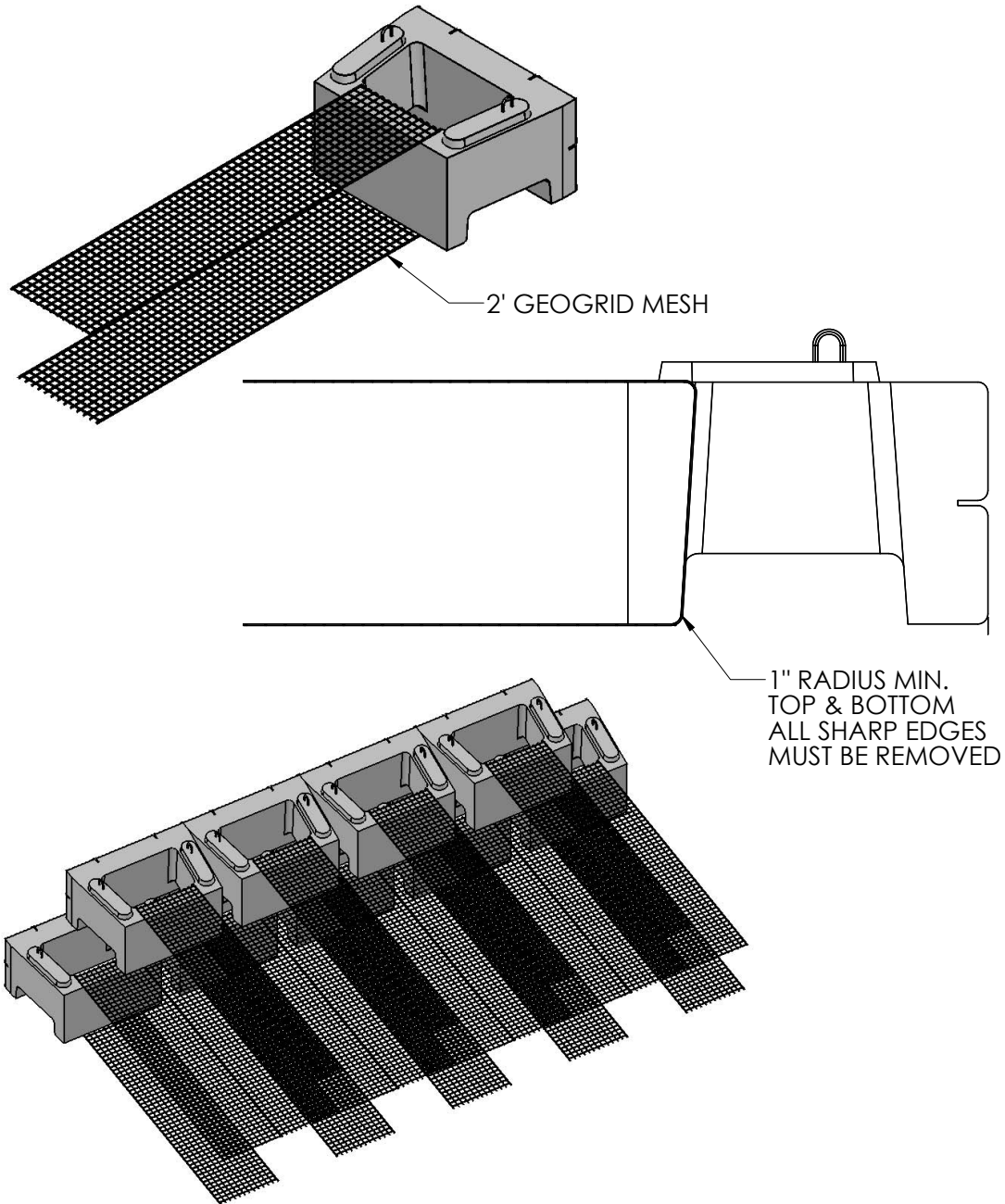

NOTE: DRAWINGS PROVIDED BY VERTI-CRETE  
ARE FOR REFERENCE ONLY. CONSULT  
LICENSED ENGINEER FOR FINAL DESIGN.



DRAWN BY	DATE	TITLE:
R FONTANESI	3/8/2016	POSITIVE CONNECTION
16500 SOUTH 500 WEST BLUFFDALE, UTAH 84065 PHONE: (801) 571-2028		DWG NO.
		WD-35
SCALE: 1: 30		SHEET 1 OF 1

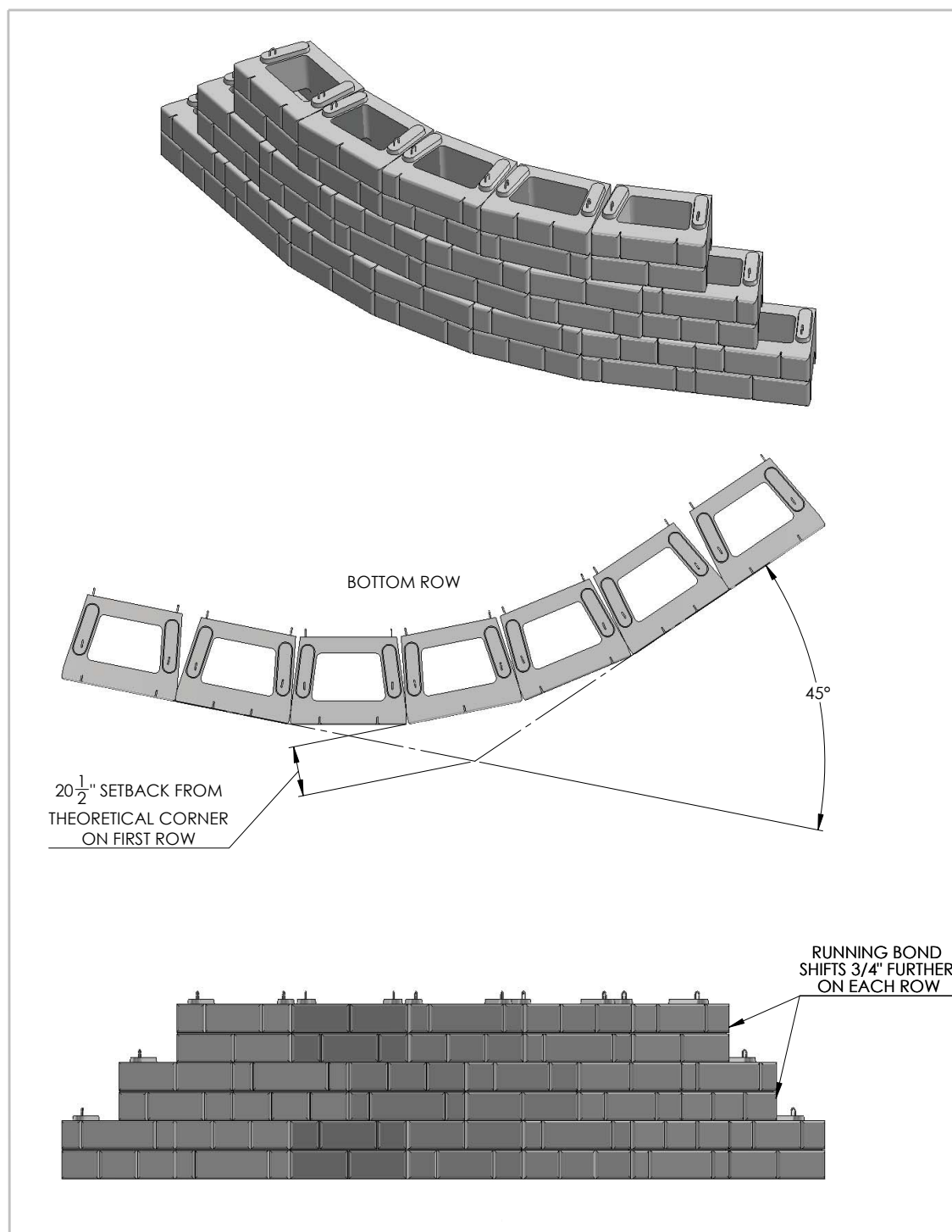

DRAWN BY	DATE	TITLE:
DAN BALLING	12/12/2013	45 ° OUTSIDE CORNER
16500 SOUTH 500 WEST BLUFFDALE, UTAH 84065 PHONE: (801) 571-2028		DWG NO.
		C-01
SCALE: 1: 50		SHEET 1 OF 1



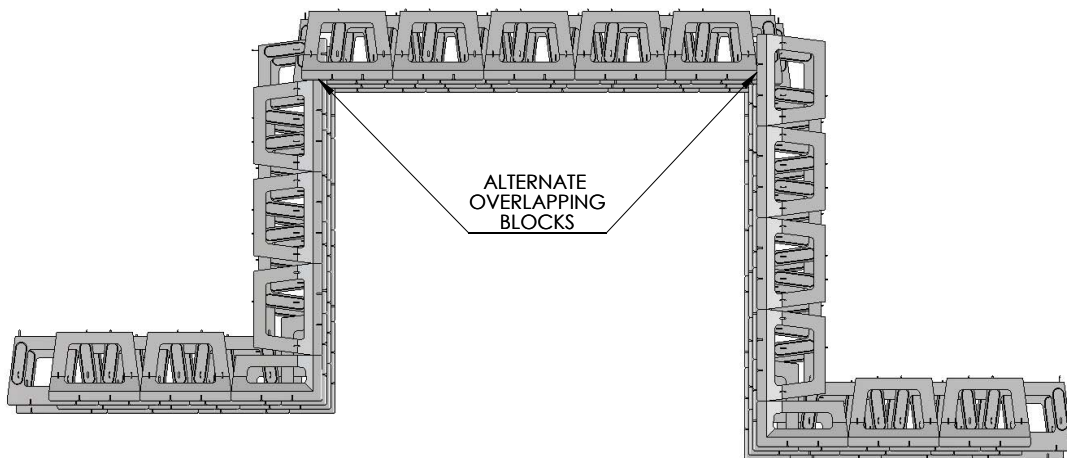
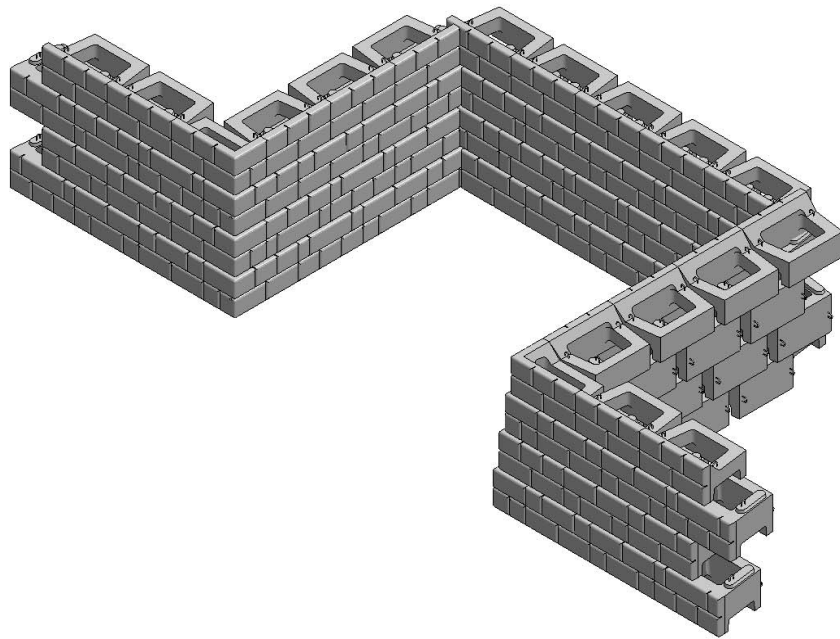

DRAWN BY	DATE	TITLE:
DAN BALLING	12/12/2013	DOUBLE 90° INSIDE CORNER
16500 SOUTH 500 WEST BLUFFDALE, UTAH 84065 PHONE: (801) 571-2028		DWG NO.
		C-02
SCALE: 1: 50		SHEET 1 OF 1

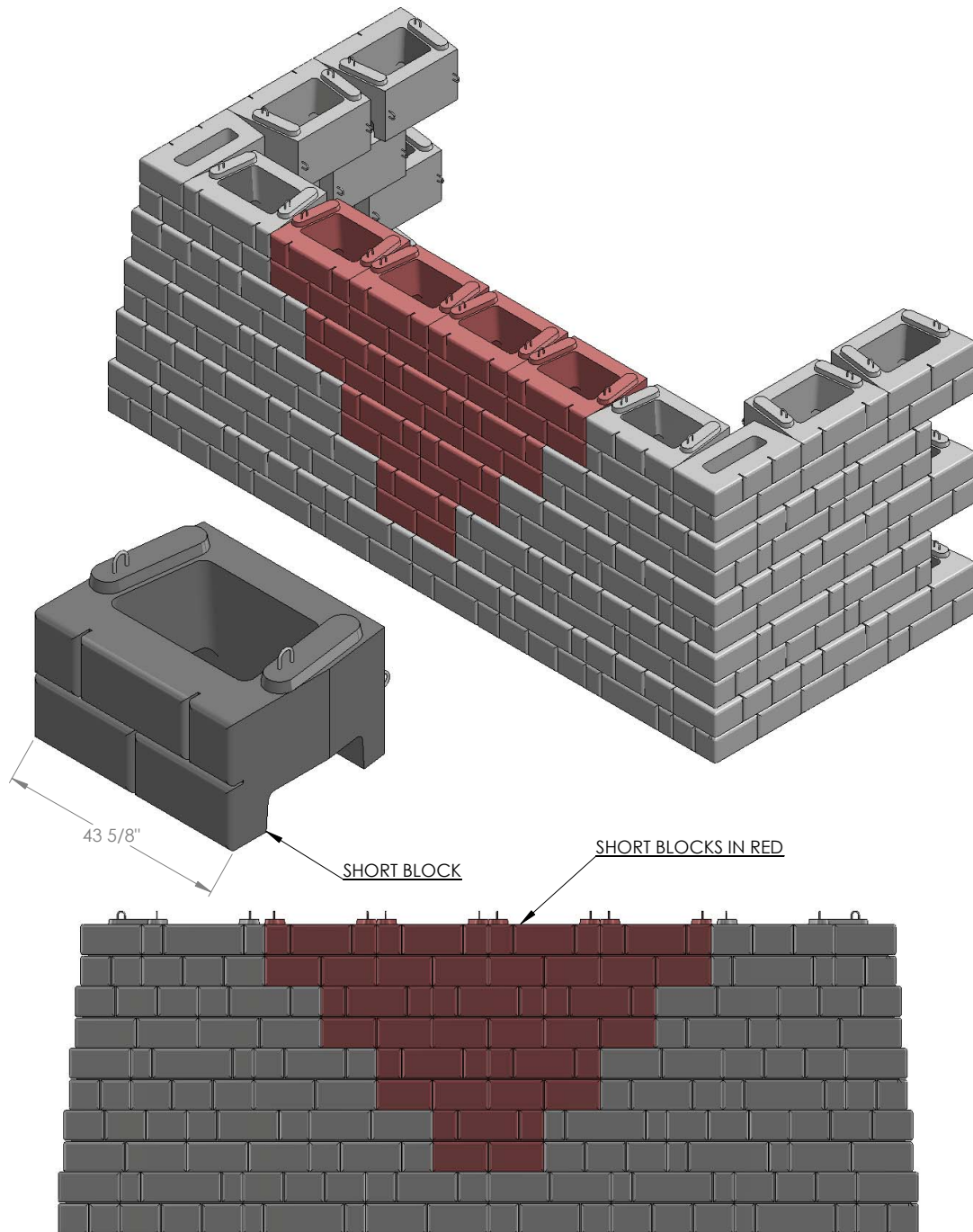

DRAWN BY	DATE	TITLE:
DAN BALLING	12/12/2013	DOUBLE 90° OUTSIDE CORNER
16500 SOUTH 500 WEST BLUFFDALE, UTAH 84065 PHONE: (801) 571-2028		DWG NO.
		C-03
SCALE: 1: 50		SHEET 1 OF 1

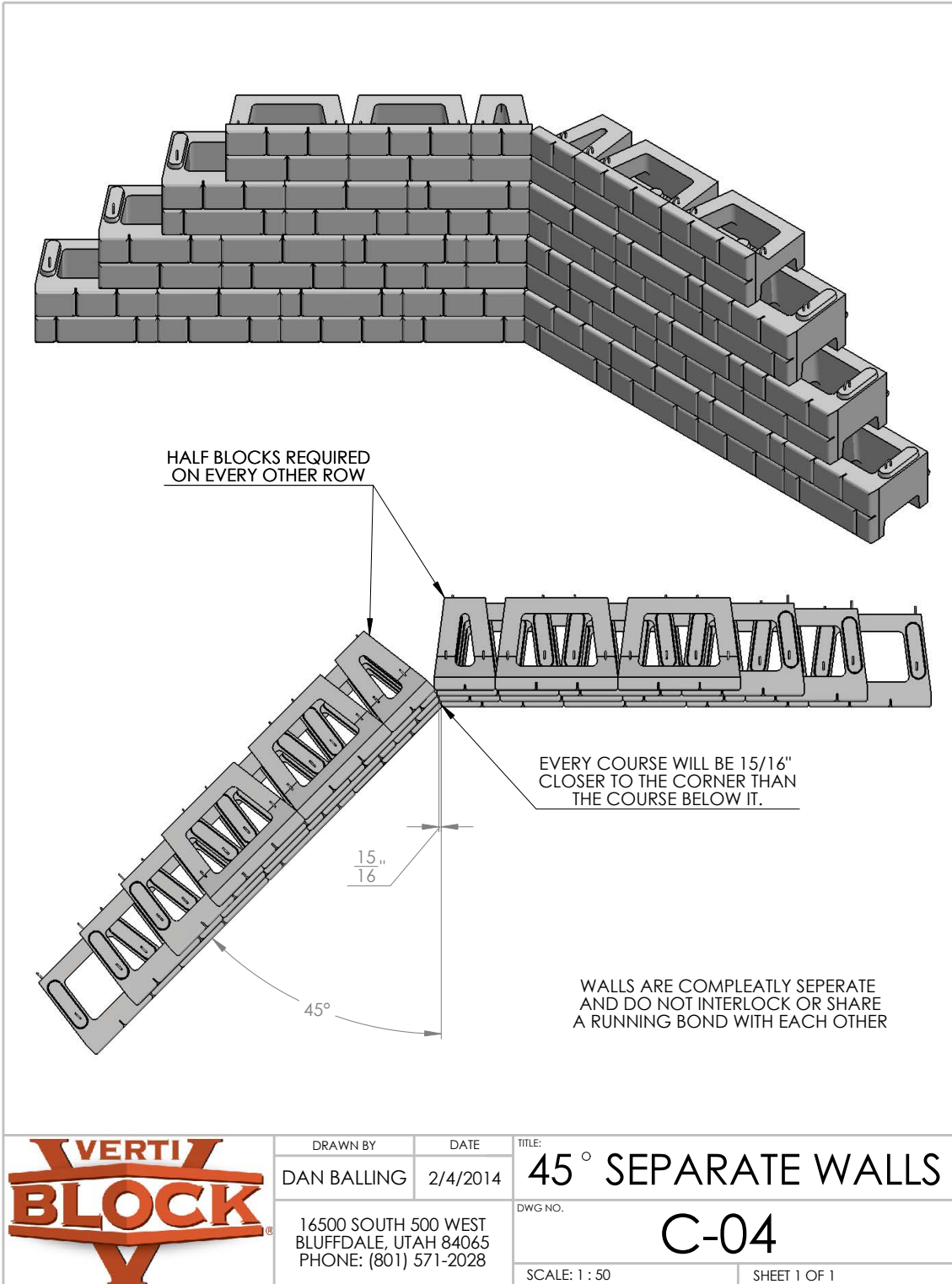

## 6 INCH CAP STEP-DOWN

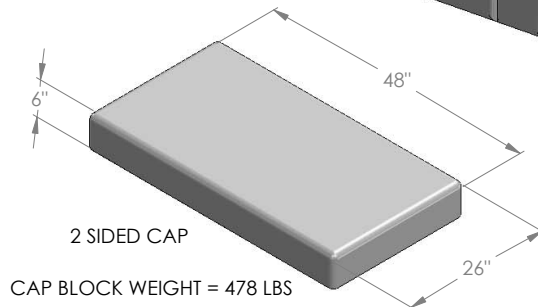
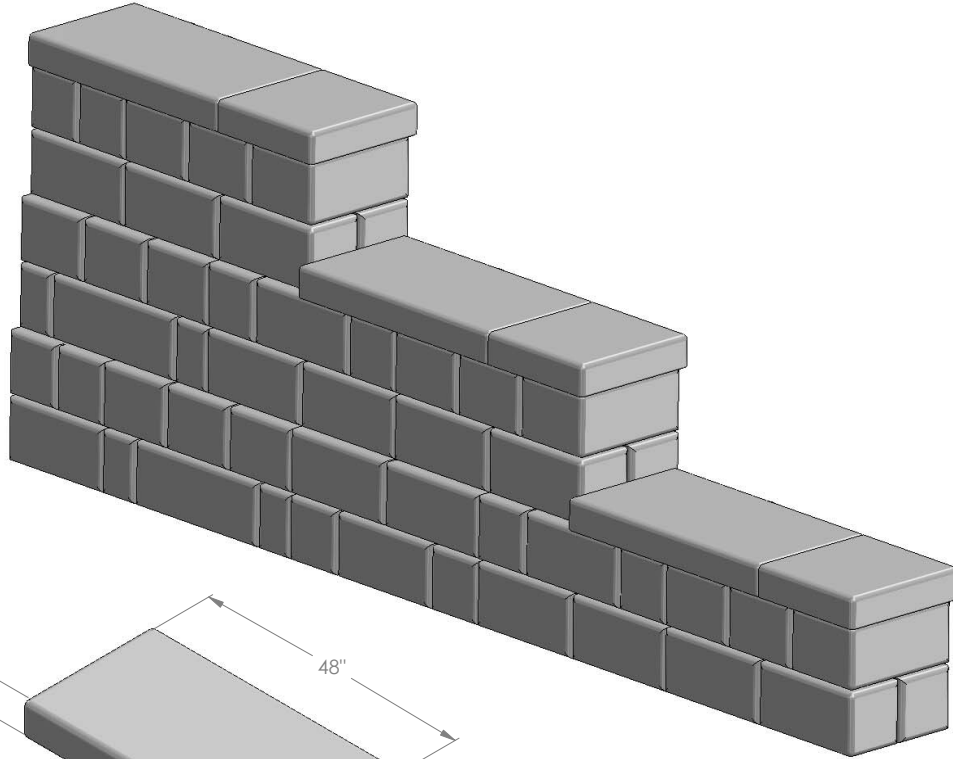

CONFLICTING AREA WILL REQUIRE THE USE OF  
A 13" NUB BLOCKOUT OR SAW CUT AND REMOVAL  
OF PICK POINT WHEN CAP IS USED

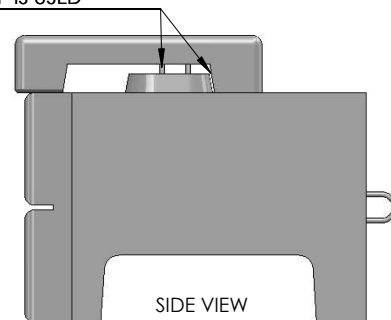
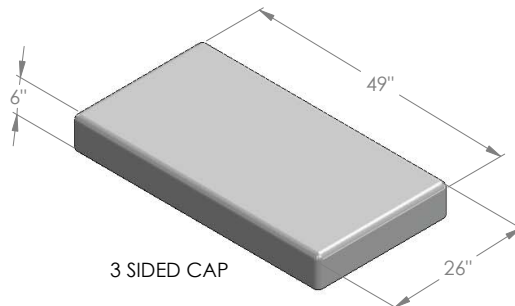

DRAWN BY	DATE	TITLE:
DAN BALLING	12/18/2013	6" CAP BLOCK SCENARIO
16500 SOUTH 500 WEST BLUFFDALE, UTAH 84065 PHONE: (801) 571-2028		DWG NO.
		CB-01
SCALE: 1: 4		SHEET 1 OF 1



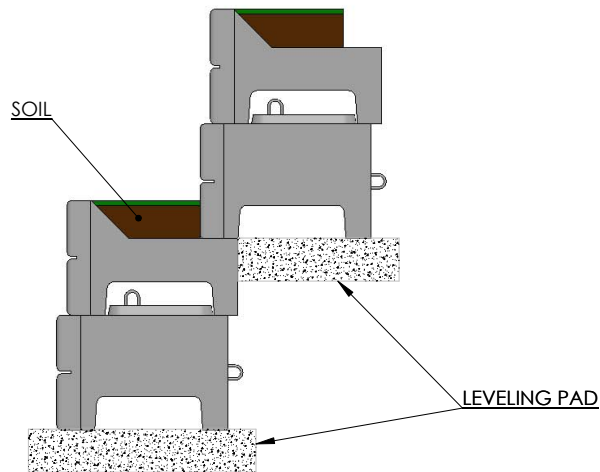
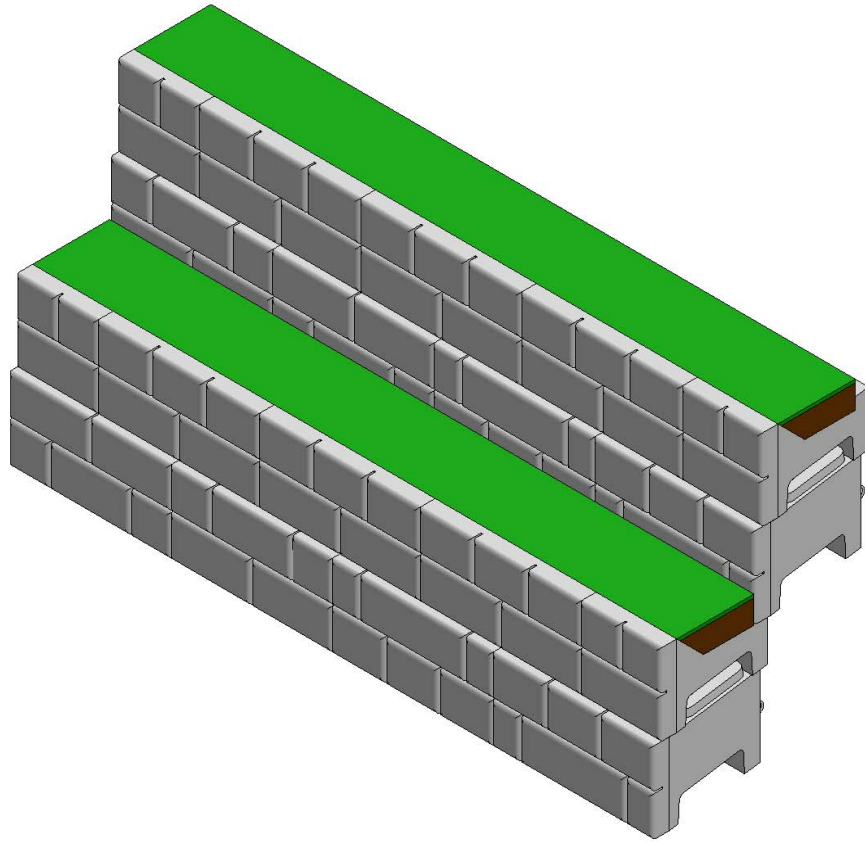

DRAWN BY	DATE
DAN BALLING	12/12/2013
16500 SOUTH 500 WEST BLUFFDALE, UTAH 84065 PHONE: (801) 571-2028	

TITLE:	PLANTER ROW WALL
DWG NO.	PR-01
SCALE: 1: 4	SHEET 1 OF 1

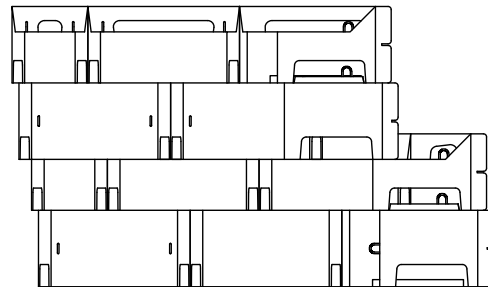
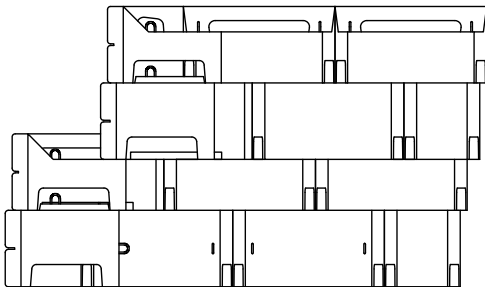
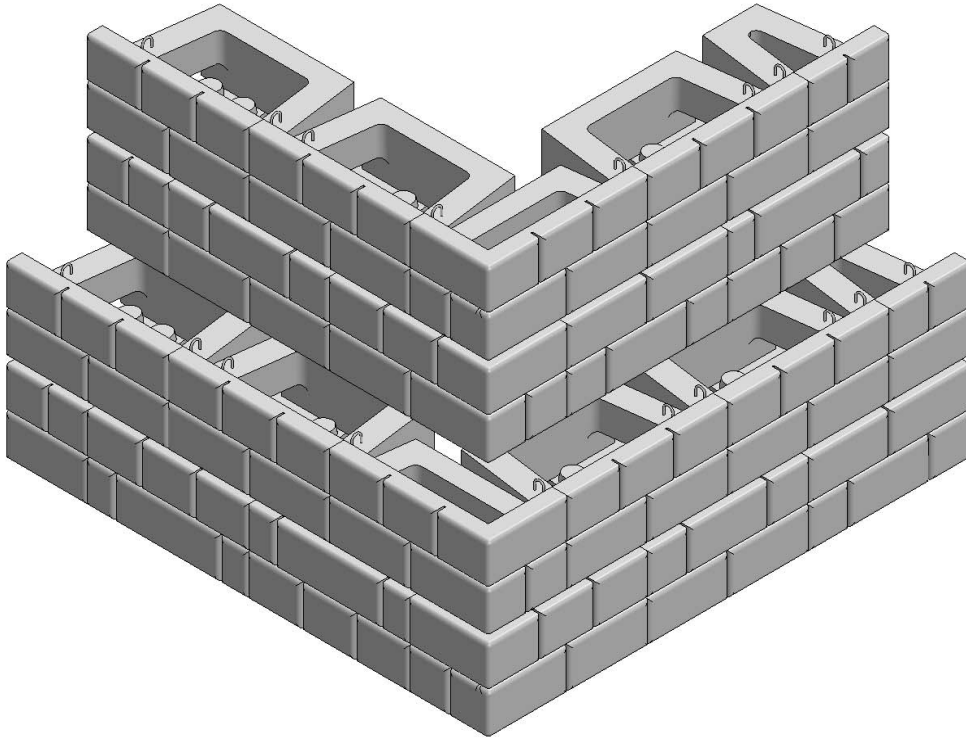

BACK SIDE VIEWS

NOTE:  
REFERENCE OUTSIDE CORNER DETAIL ON NUB BLOCKOUT



DRAWN BY	DATE	TITLE:
DAN BALLING	12/12/2013	PLANTER ROW OUTSIDE CORNER
16500 SOUTH 500 WEST BLUFFDALE, UTAH 84065 PHONE: (801) 571-2028		DWG NO.
		PR-02
SCALE: 1: 4		SHEET 1 OF 1

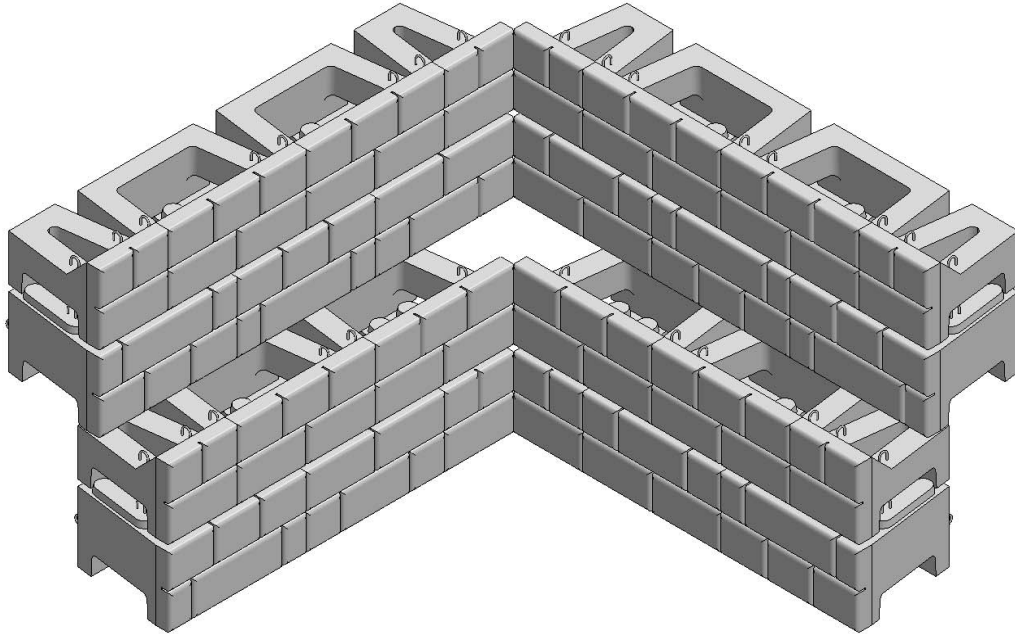

BATTER INCREASES BY 2 3/16" FOR EACH ROW

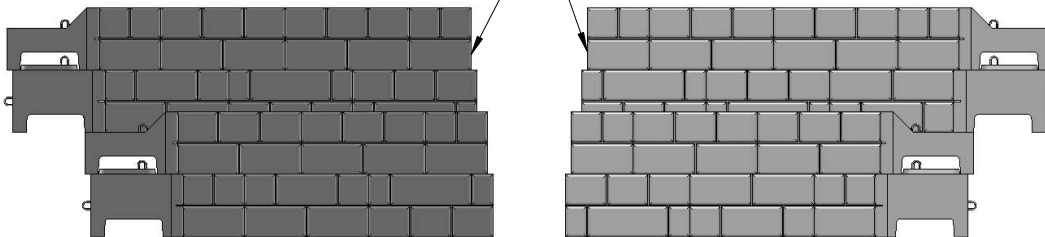

DRAWN BY	DATE	TITLE:
DAN BALLING	12/12/2013	PLANTER ROW INSIDE CORNER
16500 SOUTH 500 WEST BLUFFDALE, UTAH 84065 PHONE: (801) 571-2028		DWG NO.
		PR-03
SCALE: 1: 4		SHEET 1 OF 1

## INTERLACED INSIDE CORNER DETAIL

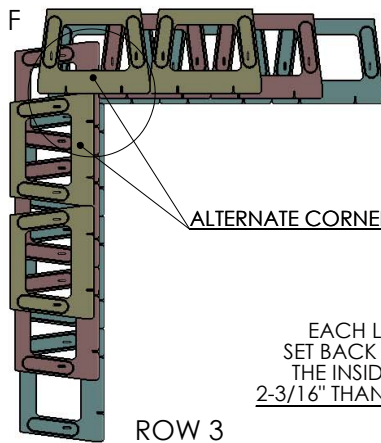
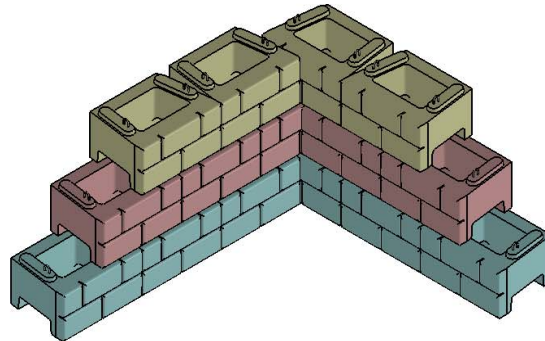

ALTERNATE CORNER OVERLAP

EACH LEVEL WILL BE  
SET BACK AND TOWARD  
THE INSIDE CORNER BY  
2-3/16" THAN THE ONE BELOW

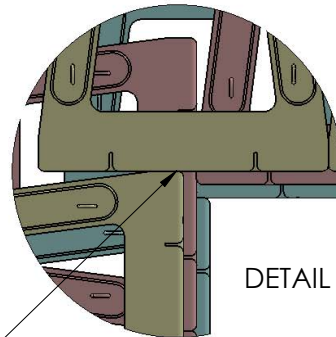

DETAIL F

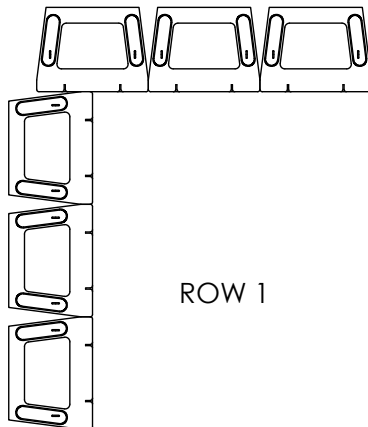

ROW 1

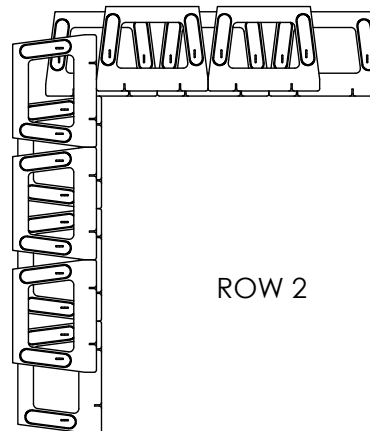

ROW 2



DRAWN BY	DATE
DAN BALLING	12/12/2013
16500 SOUTH 500 WEST BLUFFDALE, UTAH 84065 PHONE: (801) 571-2028	

TITLE:	INTERLACED INSIDE CORNER
DWG. NO.	WD-1
SCALE: 1: 60	SHEET 1 OF 1



## BUTT-JOINT INSIDE CORNER DETAIL

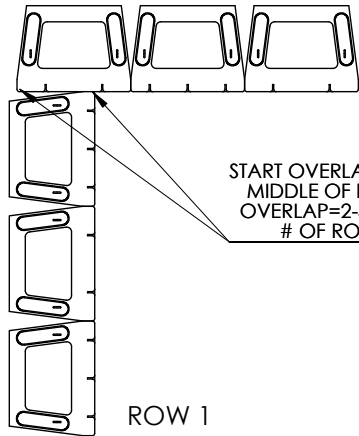
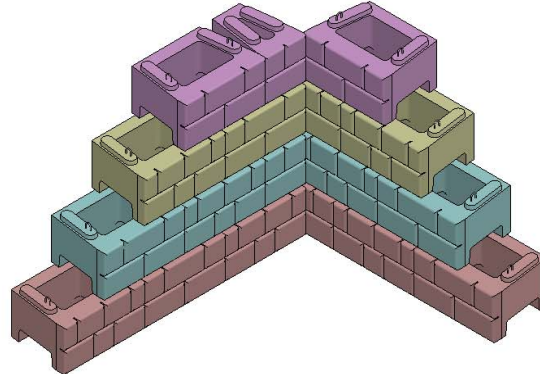

START OVERLAP FROM  
MIDDLE OF BLOCK  
OVERLAP=2-3/16" X  
# OF ROWS

ROW 1

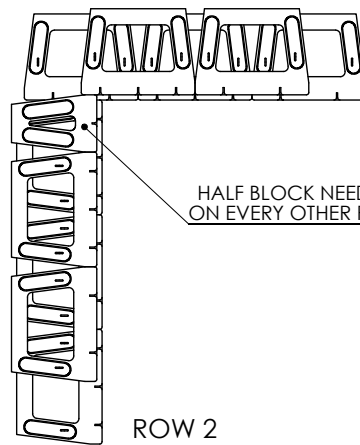

HALF BLOCK NEEDED  
ON EVERY OTHER ROW

ROW 2

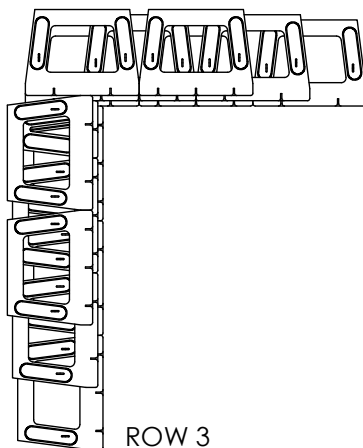

ROW 3

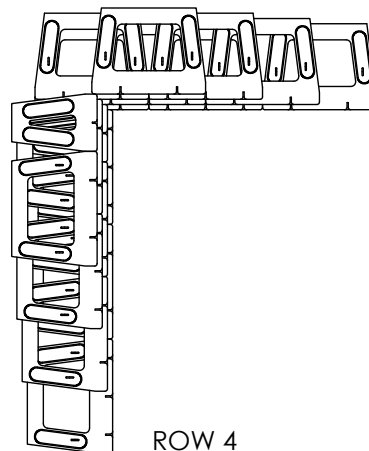

ROW 4



DRAWN BY	DATE
DAN BALLING	12/12/2013
16500 SOUTH 500 WEST BLUFFDALE, UTAH 84065 PHONE: (801) 571-2028	

TITLE:	BUTT-JOINT INSIDE CORNER
DWG NO.	WD-2
SCALE: 1: 60	SHEET 1 OF 1

## OUTSIDE CORNER DETAIL

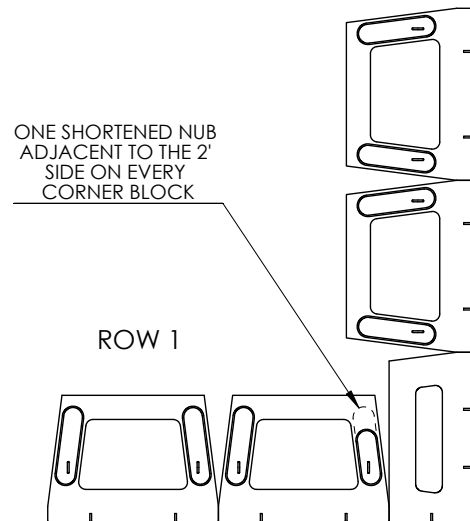
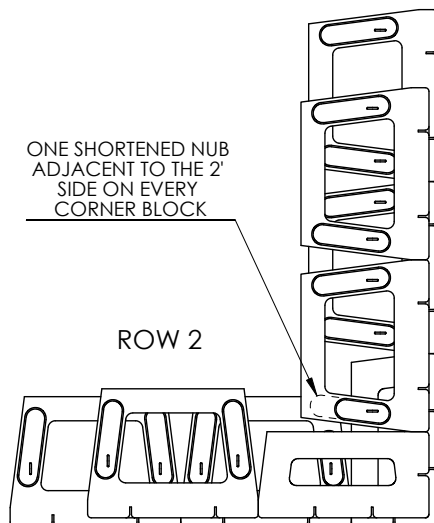
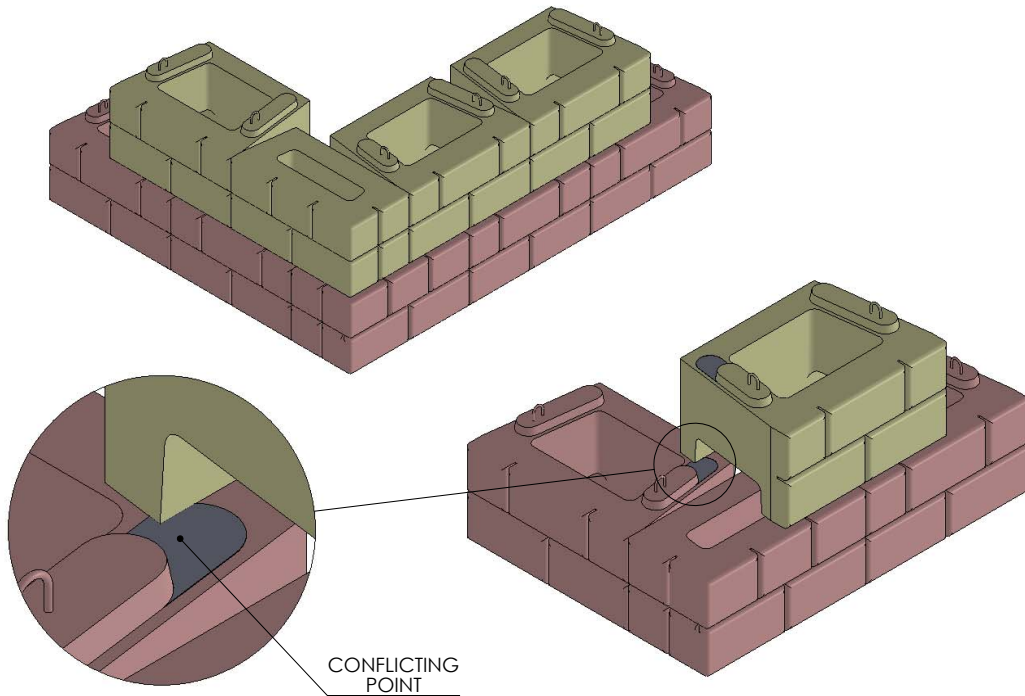

DRAWN BY	DATE
DAN BALLING	12/12/2013
16500 SOUTH 500 WEST BLUFFDALE, UTAH 84065 PHONE: (801) 571-2028	

TITLE:	OUTSIDE CORNER
DWG NO.	WD-3
SCALE: 1: 40	SHEET 1 OF 1

## OUTSIDE CORNER WITH MASS EXTENDERS DETAIL

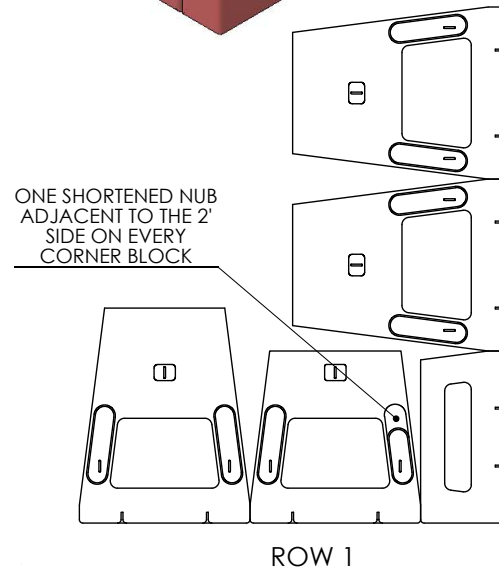
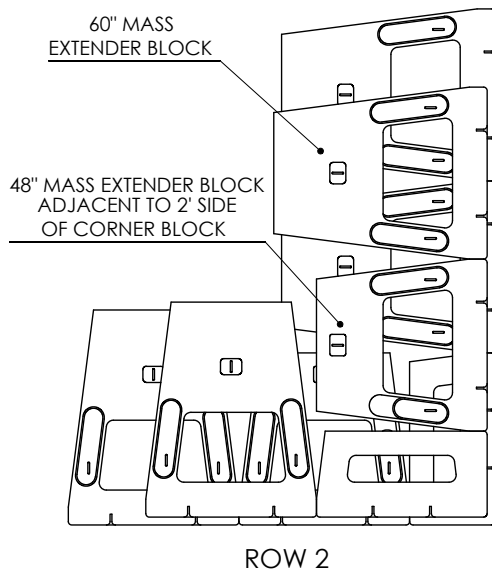
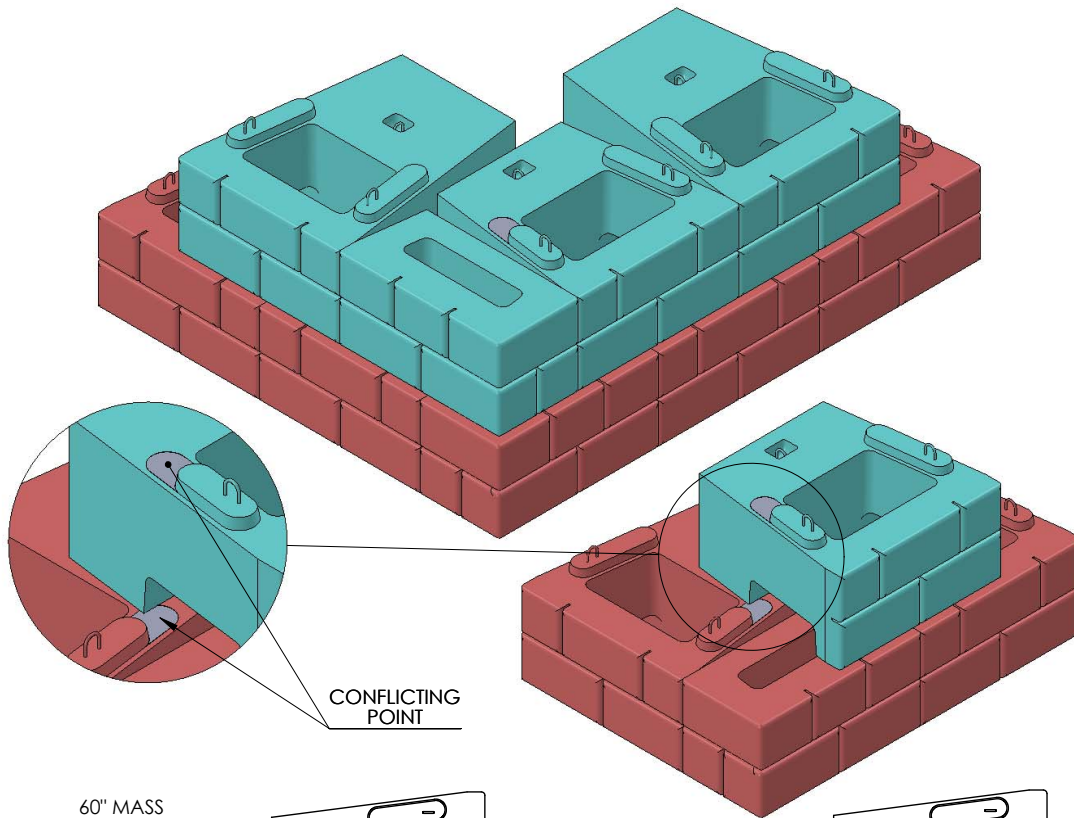

DRAWN BY	DATE	TITLE:
DAN BALLING	12/12/2013	OUTSIDE CORNER w/ ME
16500 SOUTH 500 WEST BLUFFDALE, UTAH 84065 PHONE: (801) 571-2028		DWG NO.
		WD-5
SCALE: 1: 40		SHEET 1 OF 1

## OUTSIDE CORNER WITH MASS EXTENDERS DETAIL

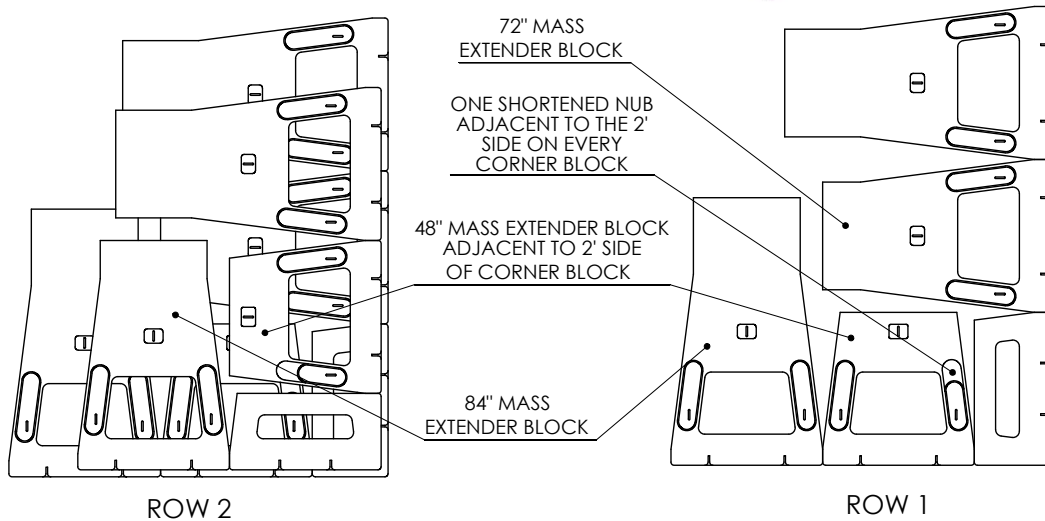
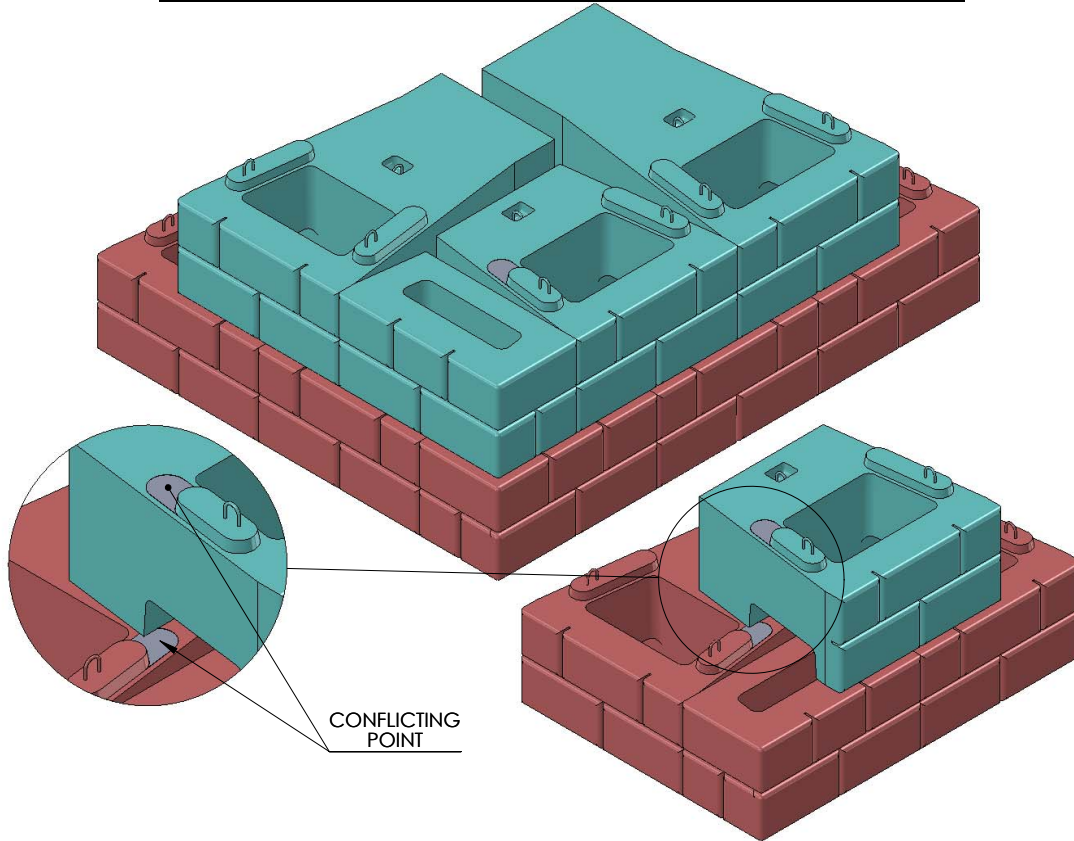

DRAWN BY	DATE	TITLE:
R FONTANESI	6/5/2015	OUTSIDE CORNER w/ 84" ME
16500 SOUTH 500 WEST BLUFFDALE, UTAH 84065 PHONE: (801) 571-2028		DWG NO.
		WD-22
SCALE: N/A		SHEET 1 OF 1



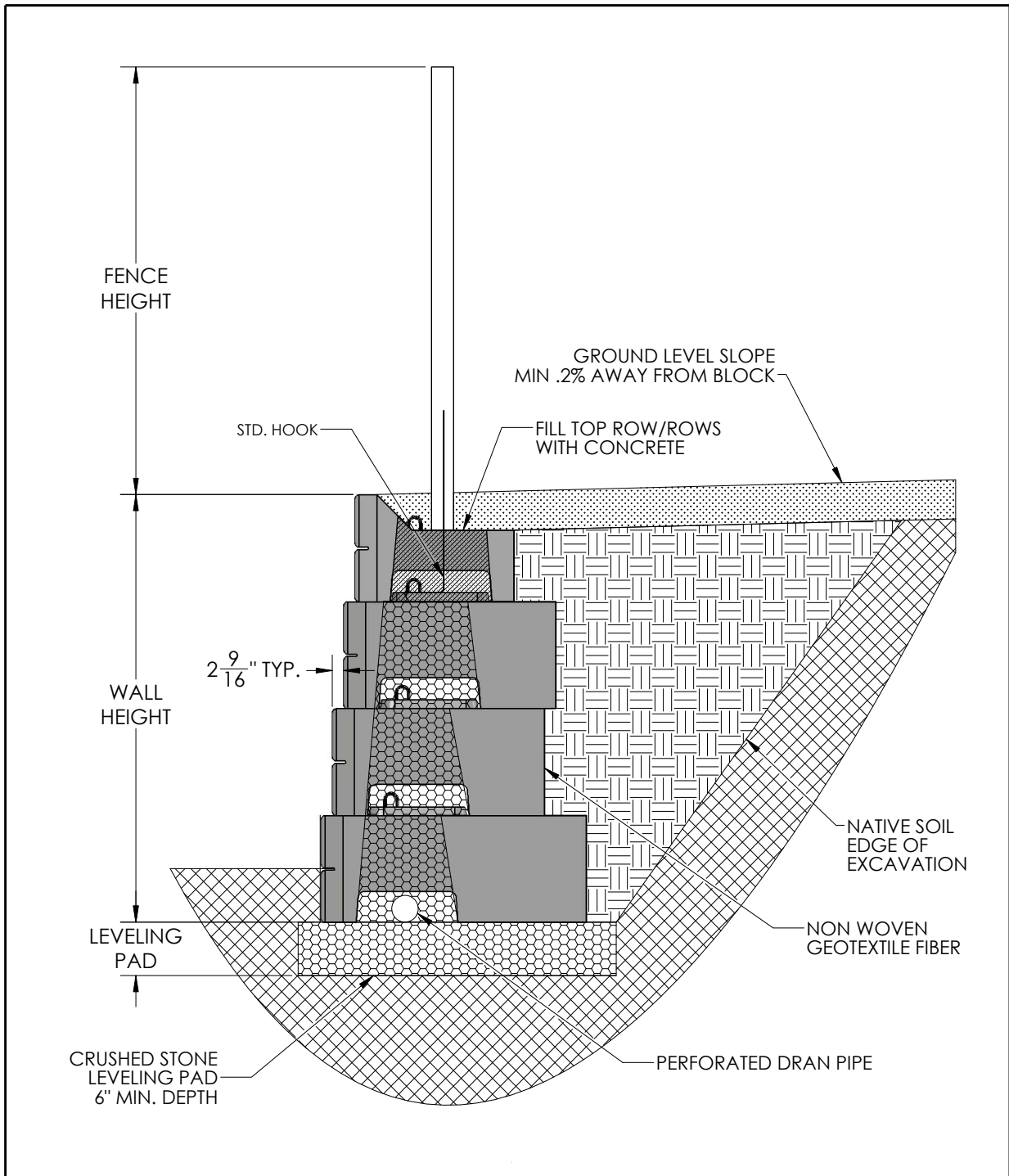

	DRAWN BY	DATE	TITLE:	
	R FONTANESI	3/4/2016	GRAVITY WALL W/ FENCE	
	16500 SOUTH 500 WEST BLUFFDALE, UTAH 84065 PHONE: (801) 571-2028		DWG NO.	WD-33
			SCALE: 1: 30	SHEET 1 OF 1

## STRAIGHT FACE WITH SIMPLE 2' RETURNS

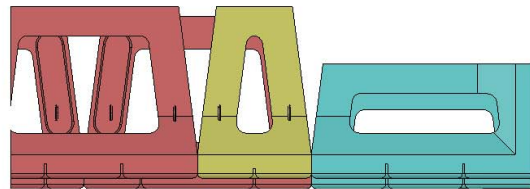
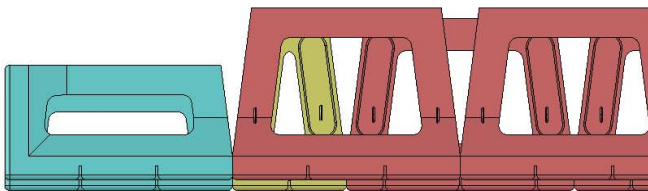
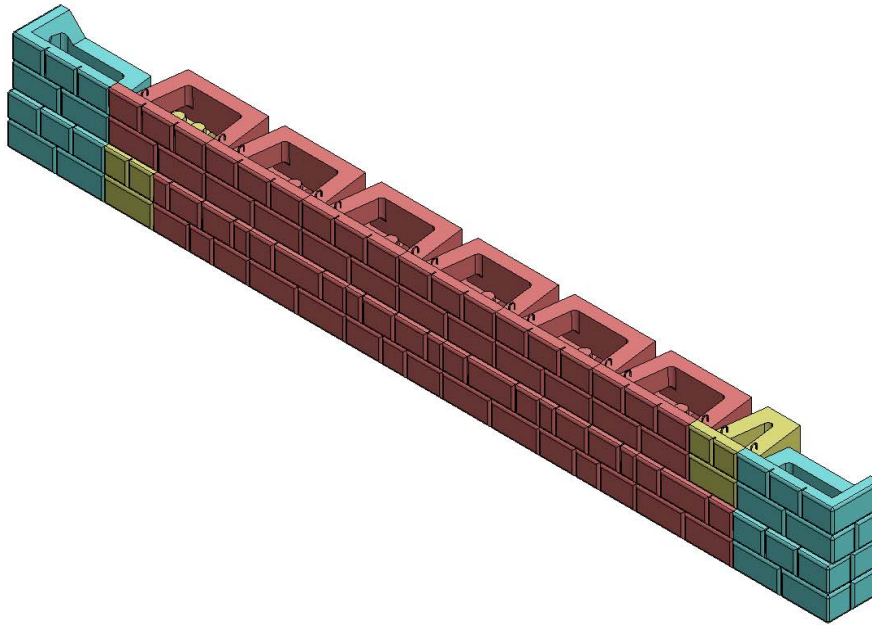

DRAWN BY	DATE
DAN BALLING	12/12/2013
16500 SOUTH 500 WEST BLUFFDALE, UTAH 84065 PHONE: (801) 571-2028	

TITLE:	2' RETURN
DWG NO.	WD-4
SCALE: 1: 40	SHEET 1 OF 1

## STRAIGHT FACE WITH SIMPLE 4' RETURNS

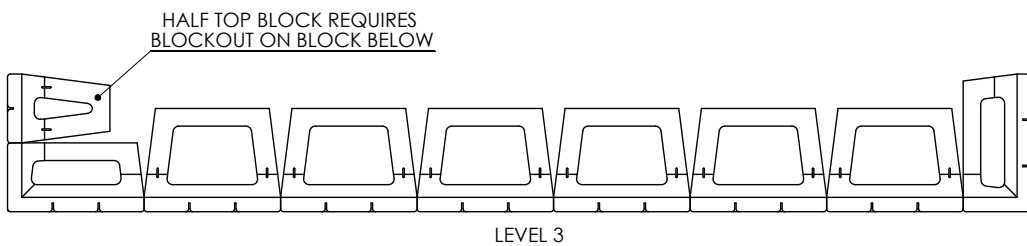
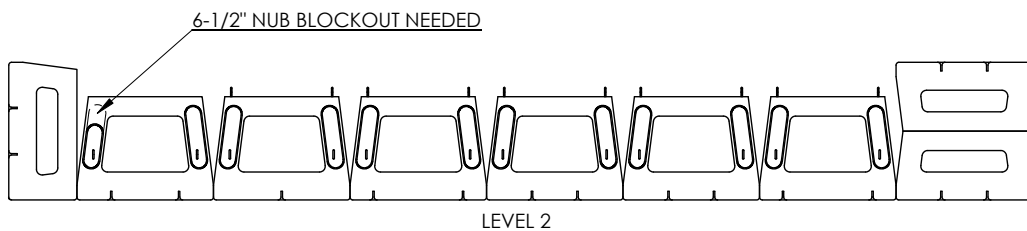
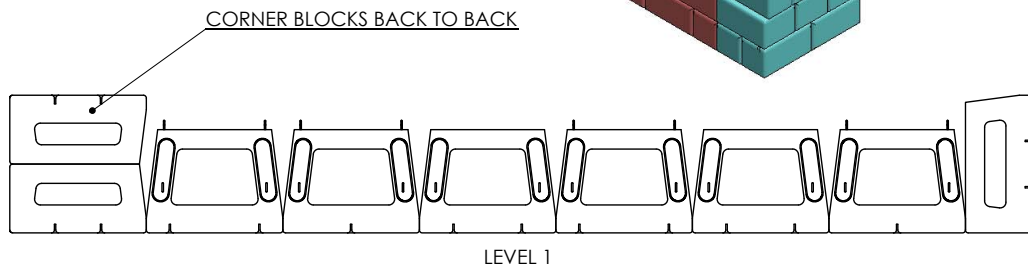
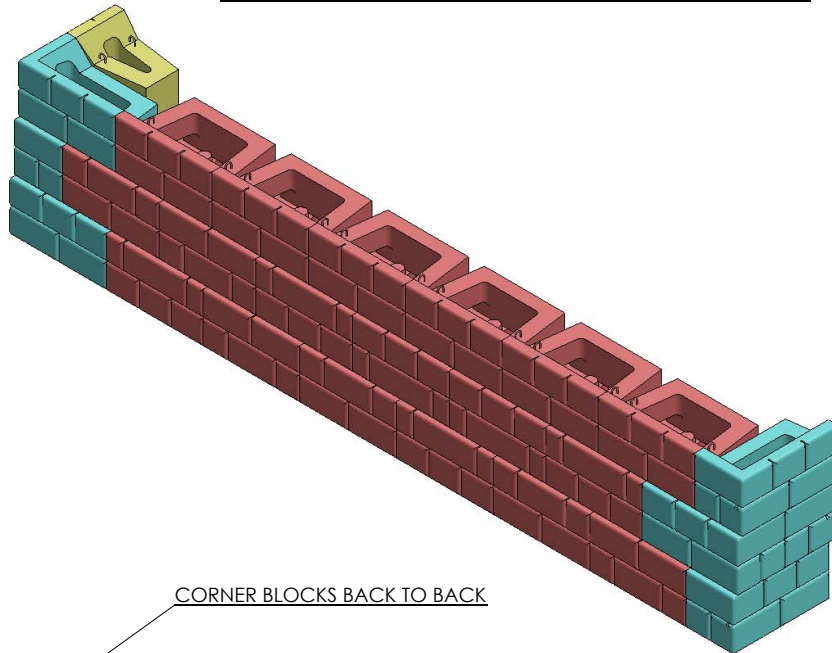

DRAWN BY	DATE	TITLE:
DAN BALLING	12/12/2013	4' RETURN
16500 SOUTH 500 WEST BLUFFDALE, UTAH 84065 PHONE: (801) 571-2028		DWG NO.
		WD-07
SCALE: 1: 4		SHEET 1 OF 1

## 2' STEP DOWN WITH TOP CORNER GAP INSERTS

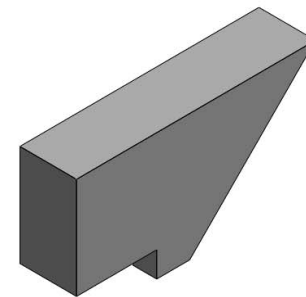
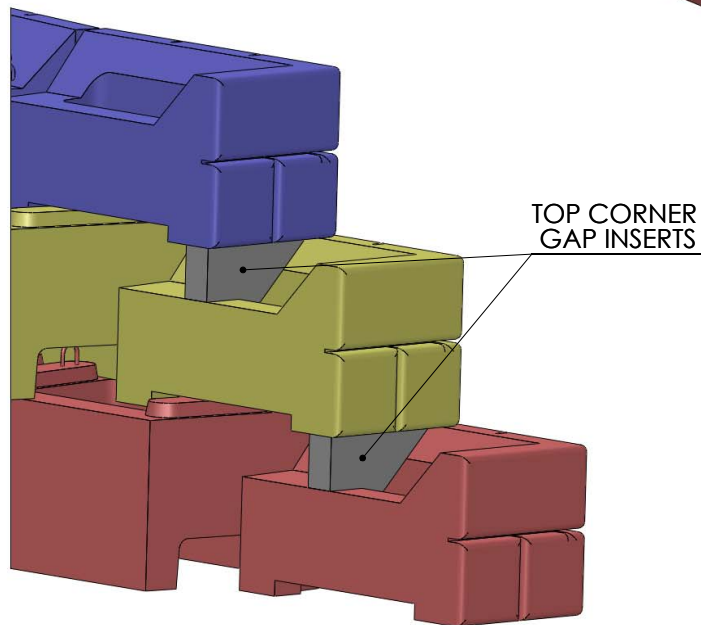
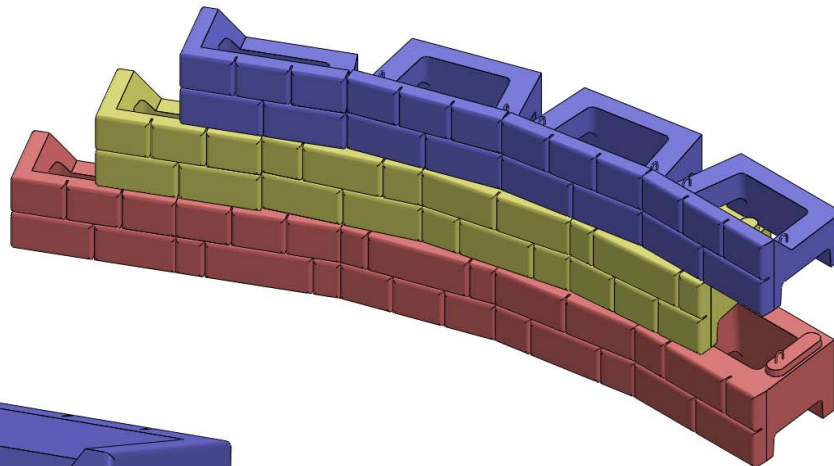

TOP CORNER GAP INSERT



DRAWN BY	DATE	TITLE:
DAN BALLING	12/12/2013	2' STEP DOWN
16500 SOUTH 500 WEST BLUFFDALE, UTAH 84065 PHONE: (801) 571-2028		DWG NO.
		WD-8
SCALE: 1: 40		SHEET 1 OF 1



## 6' STEP DOWN WITH TOP STANDARD GAP INSERT

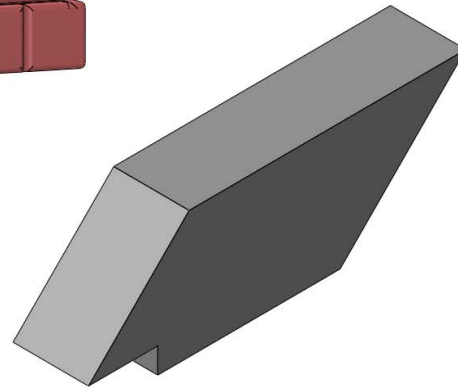
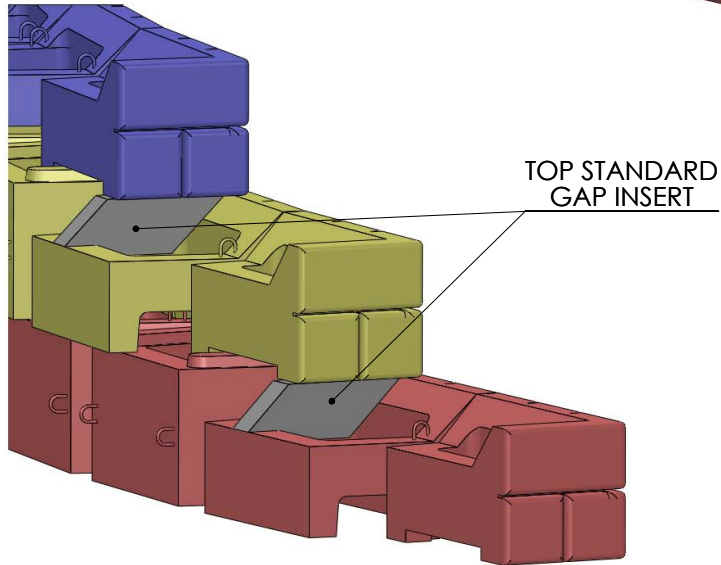
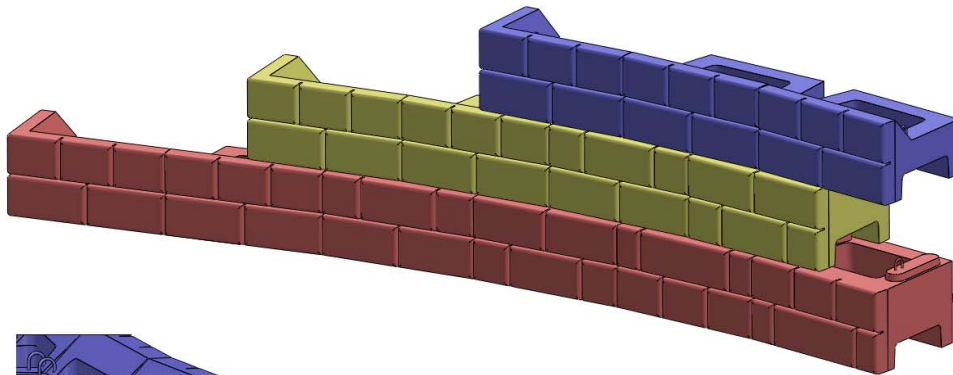

TOP STANDARD GAP INSERT



DRAWN BY	DATE	TITLE:
DAN BALLING	12/12/2013	6' STEP DOWN
16500 SOUTH 500 WEST BLUFFDALE, UTAH 84065 PHONE: (801) 571-2028		DWG NO. WD-9
SCALE: 1: 40		SHEET 1 OF 1

## 6' STEP DOWN WITH HALF-STEP BLOCK AND TOP CORNER GAP INSERT

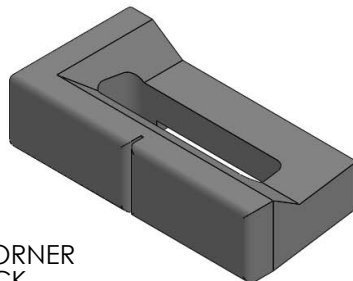
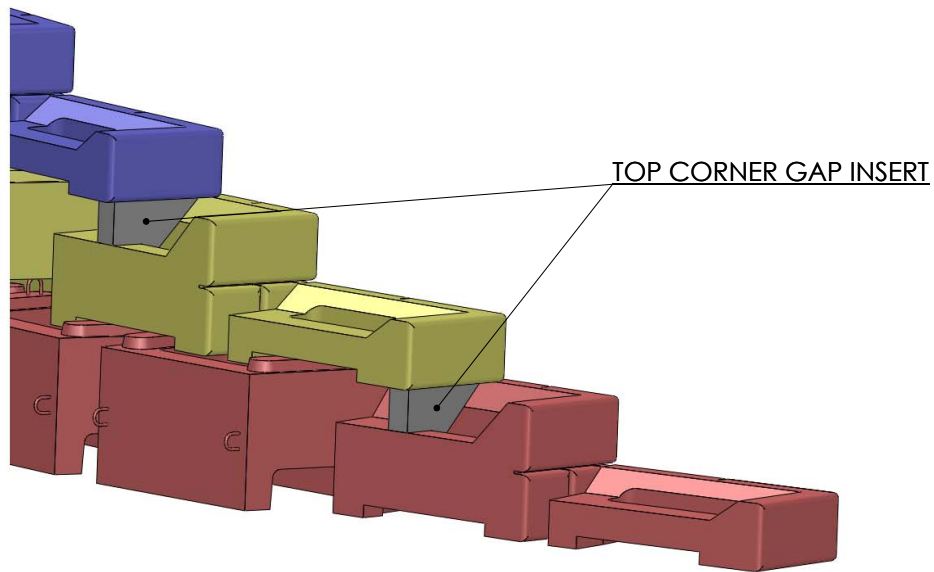
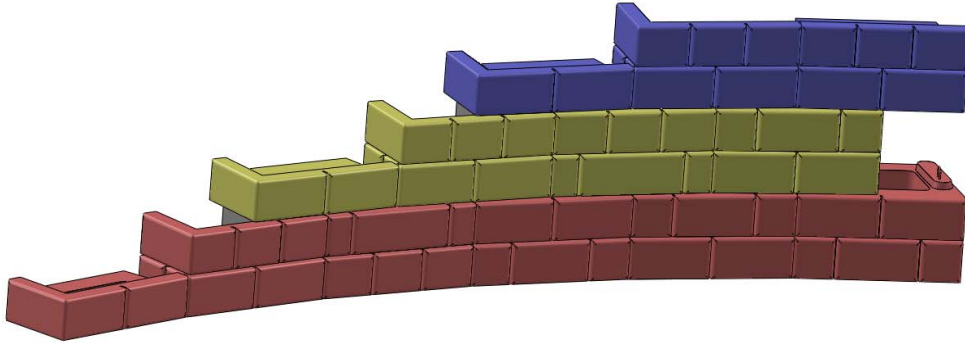

HALF-STEP CORNER  
TOP BLOCK

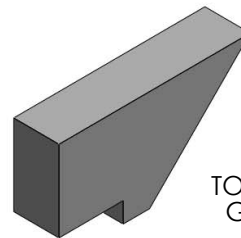

TOP CORNER  
GAP INSERT



DRAWN BY  
DAN BALLING

DATE  
12/12/2013

16500 SOUTH 500 WEST  
BLUFFDALE, UTAH 84065  
PHONE: (801) 571-2028

TITLE:  
6' STEP W/ HALF STEP BLOCK

DWG NO.

WD-10

SCALE: 1: 40

SHEET 1 OF 1

## 10' STEP DOWN WITH HALF-STEP BLOCK AND TOP STANDARD GAP INSERT

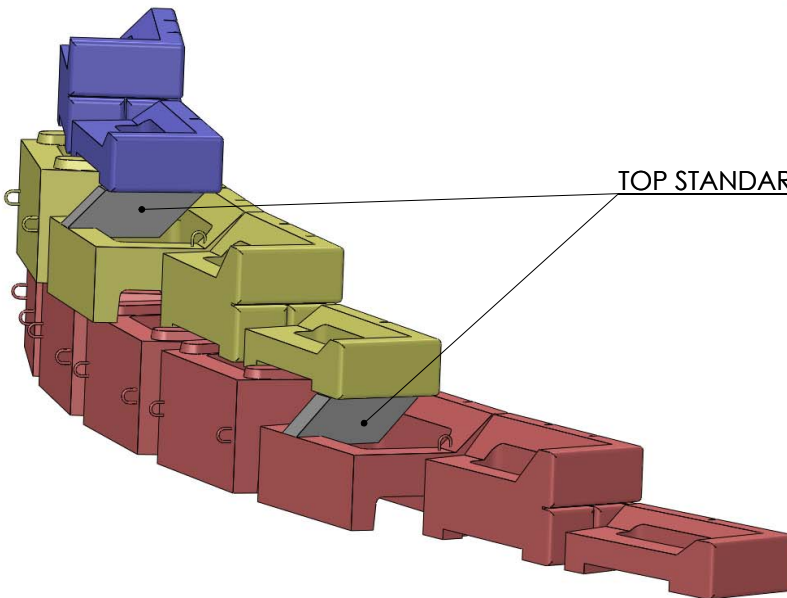
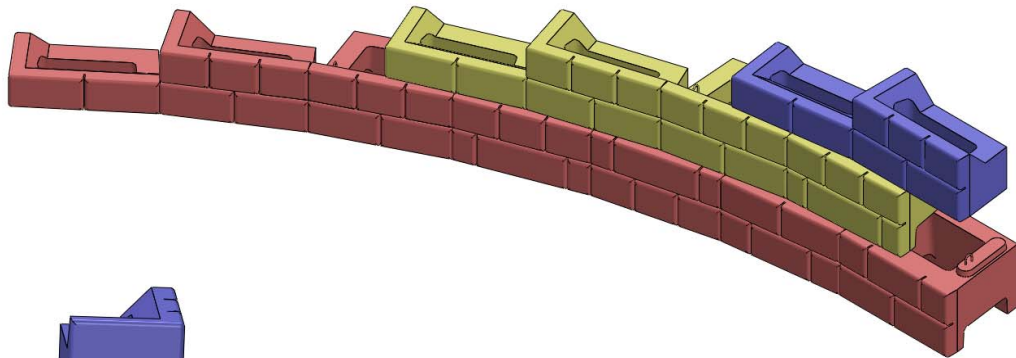

TOP STANDARD GAP INSERT

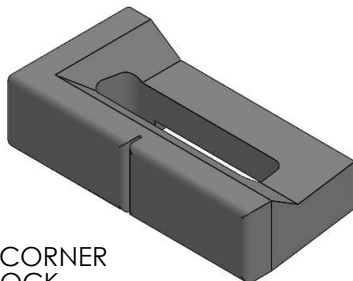

HALF-STEP CORNER  
TOP BLOCK

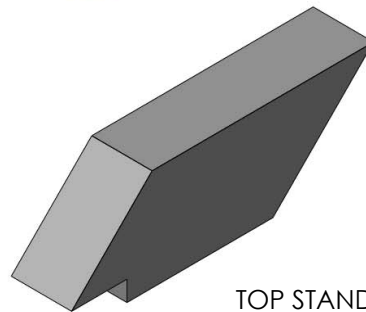

TOP STANDARD  
GAP INSERT



DRAWN BY	DATE	TITLE:
DAN BALLING	12/12/2013	10' STEP W/ HALF STEP BLOCK
16500 SOUTH 500 WEST BLUFFDALE, UTAH 84065 PHONE: (801) 571-2028		DWG NO.
		WD-11
SCALE: 1: 40		SHEET 1 OF 1

## OUTSIDE CURVE DETAIL

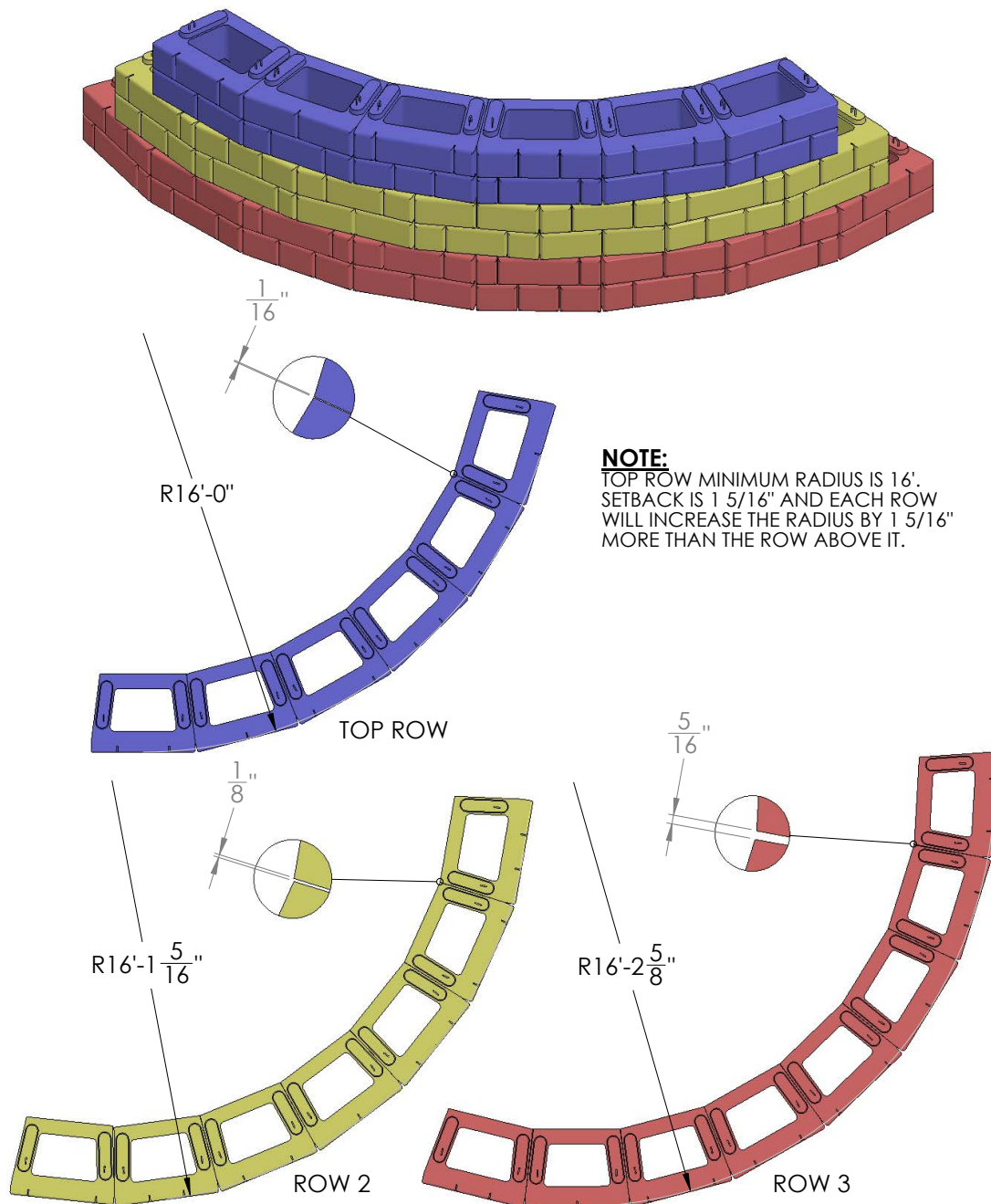

DRAWN BY	DATE
DAN BALLING	12/12/2013
16500 SOUTH 500 WEST BLUFFDALE, UTAH 84065 PHONE: (801) 571-2028	

TITLE:	OUTSIDE CURVE
DWG NO.	WD-6
SCALE: 1: 40	SHEET 1 OF 1

## INSIDE CURVE DETAIL

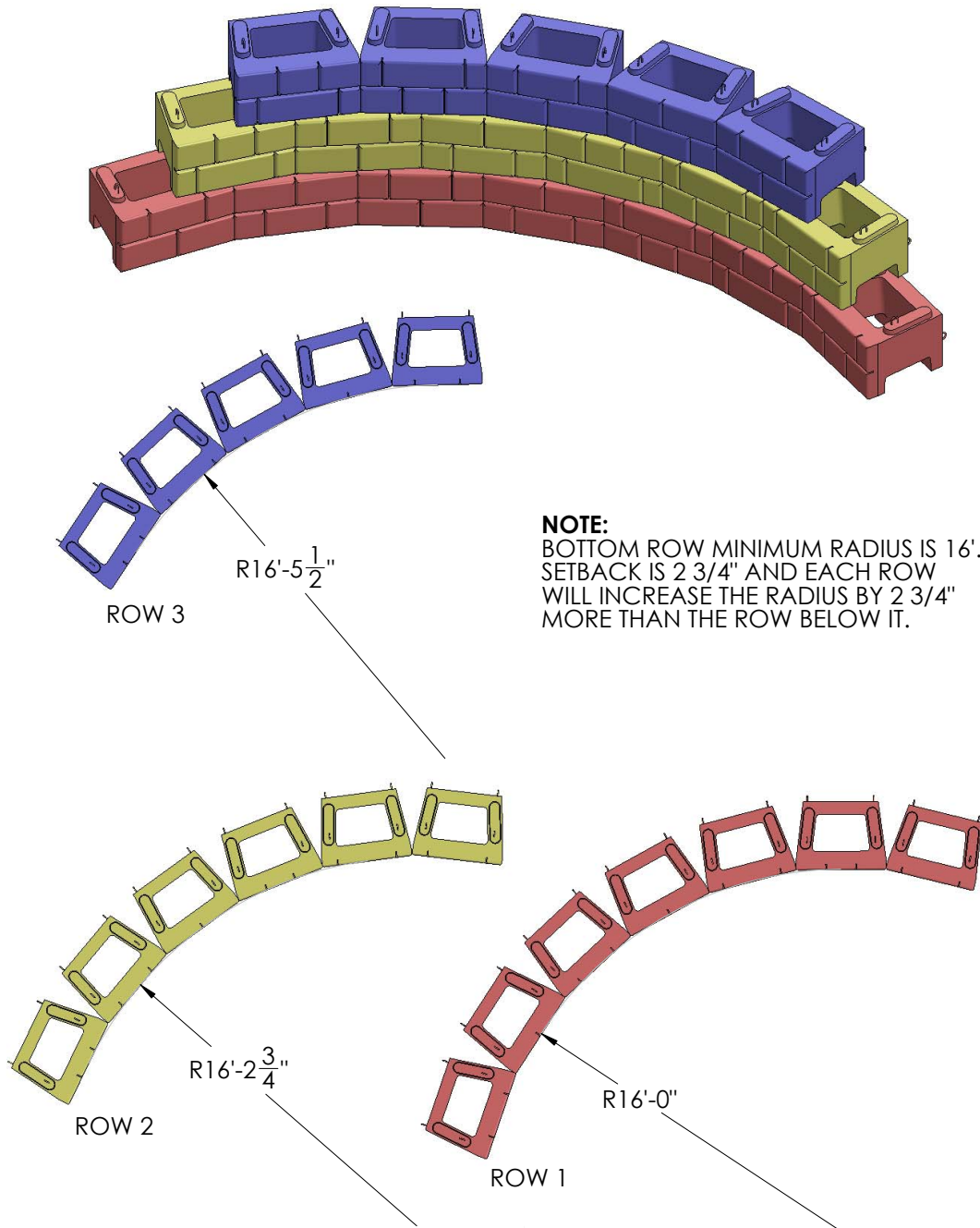

DRAWN BY	DATE
DAN BALLING	12/12/2013
16500 SOUTH 500 WEST BLUFFDALE, UTAH 84065 PHONE: (801) 571-2028	

TITLE:	INSIDE CURVE
DWG NO.	WD-12
SCALE: 1: 40	SHEET 1 OF 1



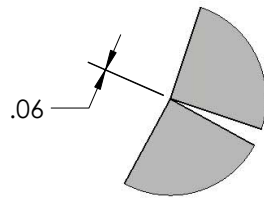
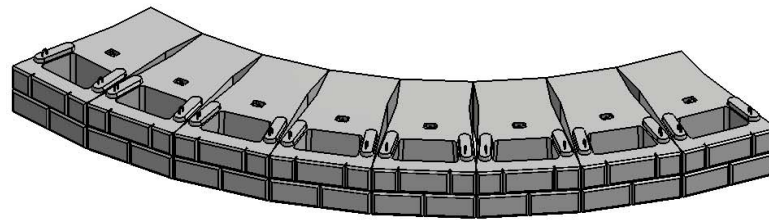

DETAIL A

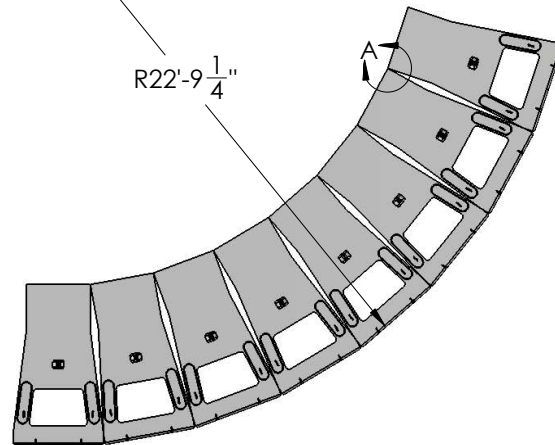

DRAWN BY	DATE
R FONTANESI	4/14/2015
16500 SOUTH 500 WEST BLUFFDALE, UTAH 84065 PHONE: (801) 571-2028	

TITLE:		
OUTSIDE CURVE W/ 84" ME		
DWG NO.		
WD-21		
SCALE: NA	REVISION: 01	SHEET 1 OF 1

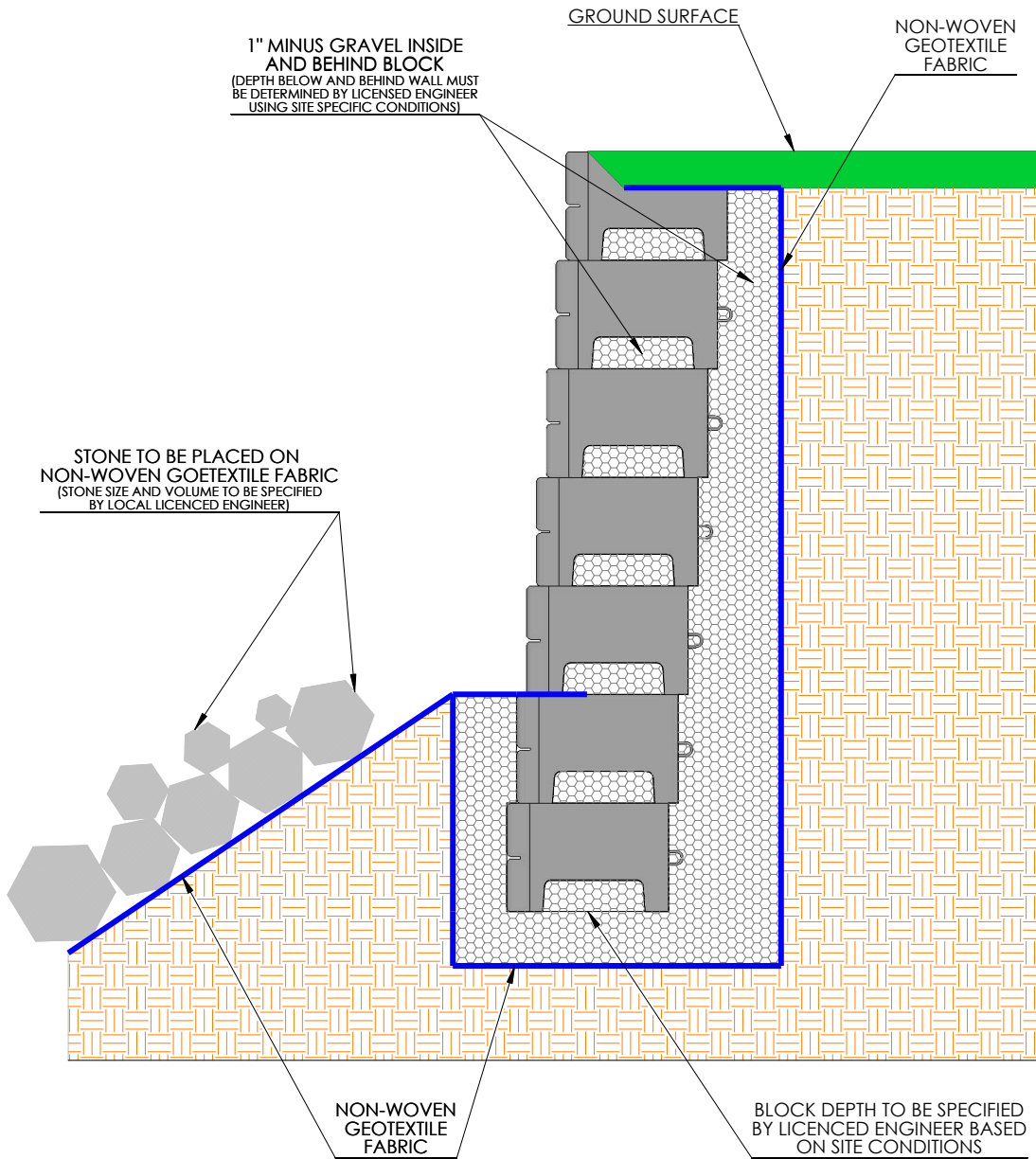

NOTE:  
SEA WALLS MUST BE DESIGNED AND CHECKED BY LICENSED PROFESSIONAL ENGINEER DUE TO THE HIGH VARIETY OF VARIABLES FOR ANY GIVEN APPLICATION.



DRAWN BY	DATE	TITLE:
DAN BALLING	12/12/2013	SEA WALL DETAIL
16500 SOUTH 500 WEST BLUFFDALE, UTAH 84065 PHONE: (801) 571-2028		DWG NO.
		WD-13
SCALE: 1: 4		SHEET 1 OF 1

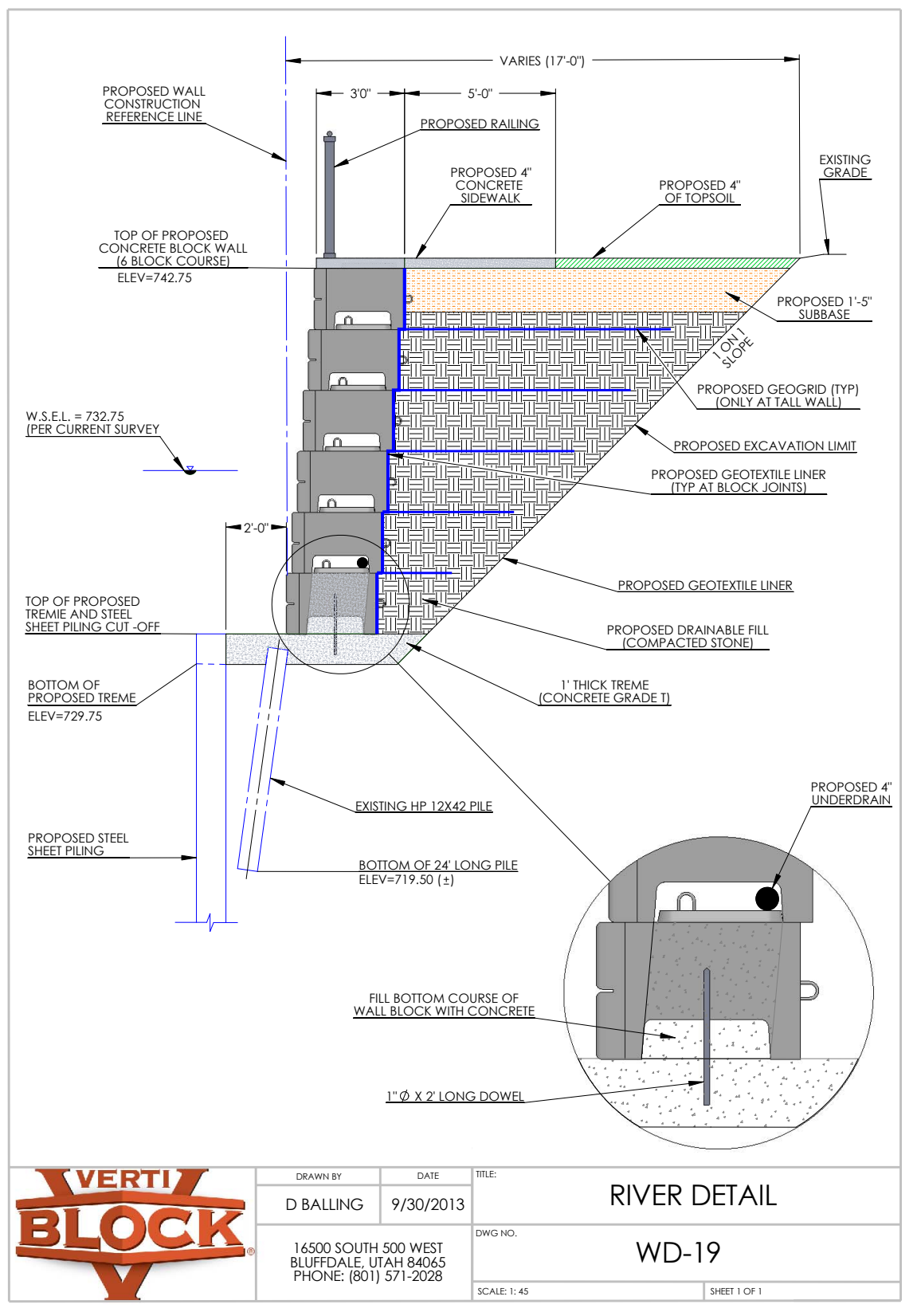

## LAKESHORE WALL DETAIL

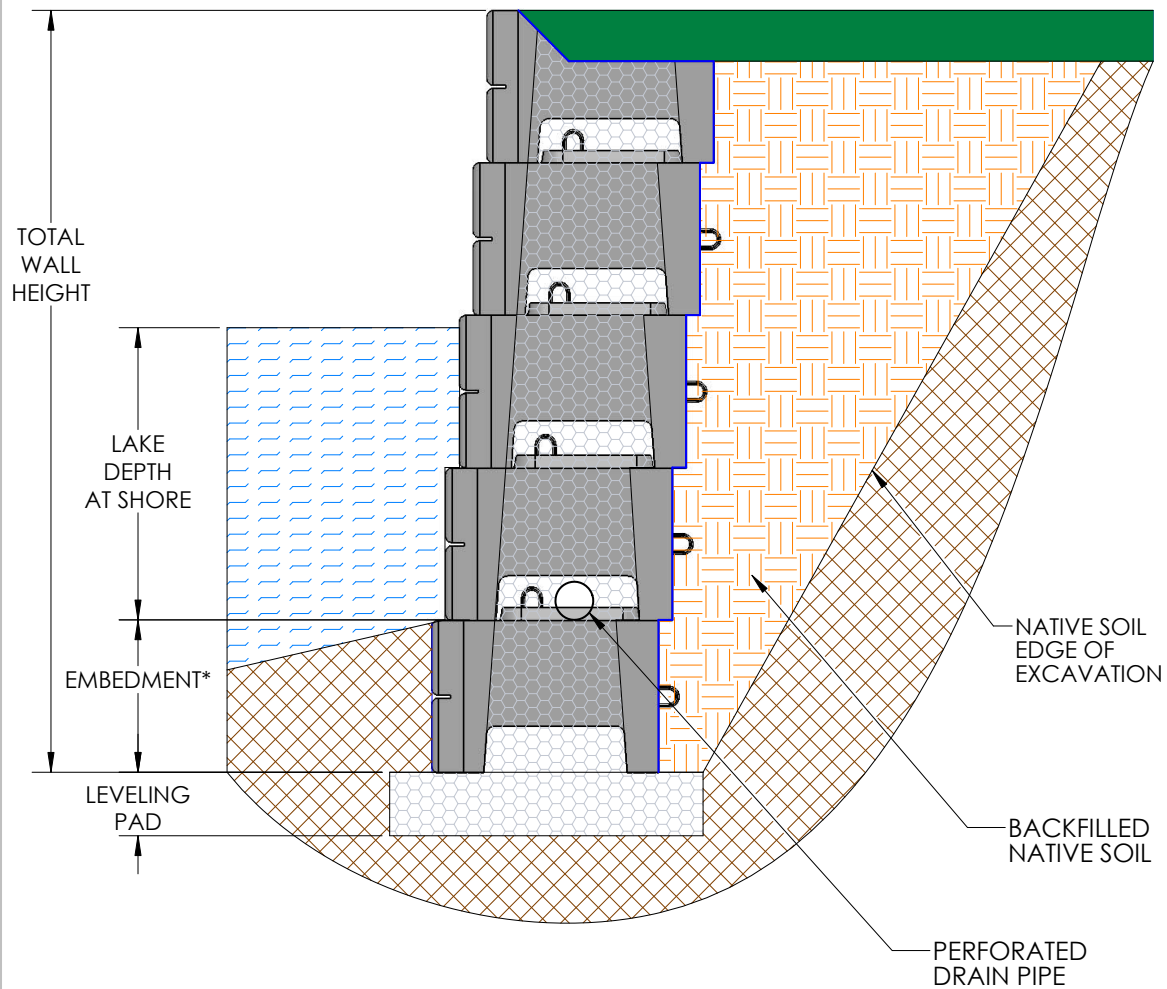

\*EMBEDMENT MUST BE DEEP ENOUGH FOR LEVELING PAD TO BE BELOW SCOUR LINE



DRAWN BY	DATE	TITLE:
R FONTANESI	11/16/2016	LAKESHORE WALL
16500 SOUTH 500 WEST BLUFFDALE, UTAH 84065 PHONE: (801) 571-2028		DWG NO.
		WD-42
SCALE: 1: 30		SHEET 1 OF 1

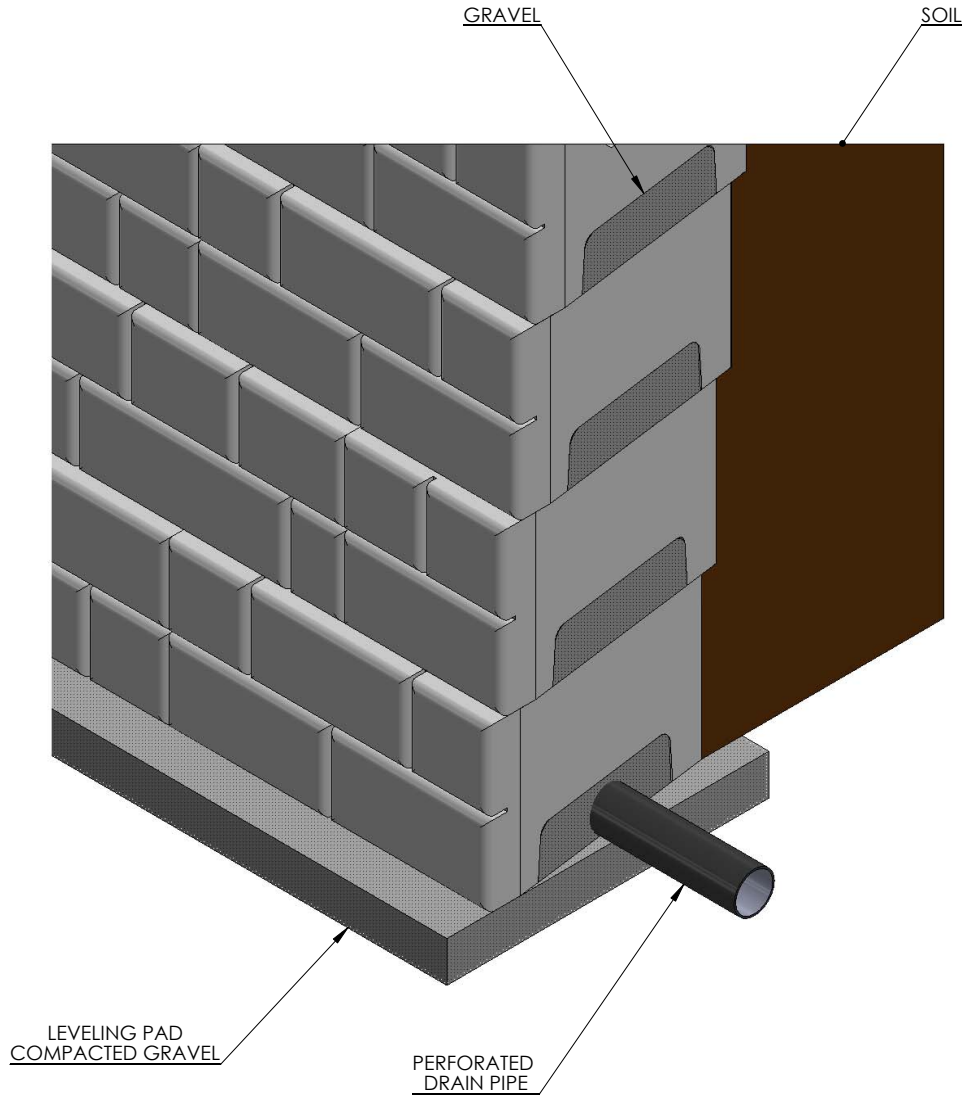

DRAIN PIPE IS PLACED INSIDE GAP AT THE BOTTOM OF THE BLOCK AND ON TOP OF THE LEVELING PAD THEN COVERED WITH GRAVEL.



DRAWN BY	DATE	TITLE:
DAN BALLING	12/18/2013	DRAIN PLACEMENT-OPTION #1
16500 SOUTH 500 WEST BLUFFDALE, UTAH 84065 PHONE: (801) 571-2028		DWG NO.
		WD-16
SCALE: 1: 20		SHEET 1 OF 1



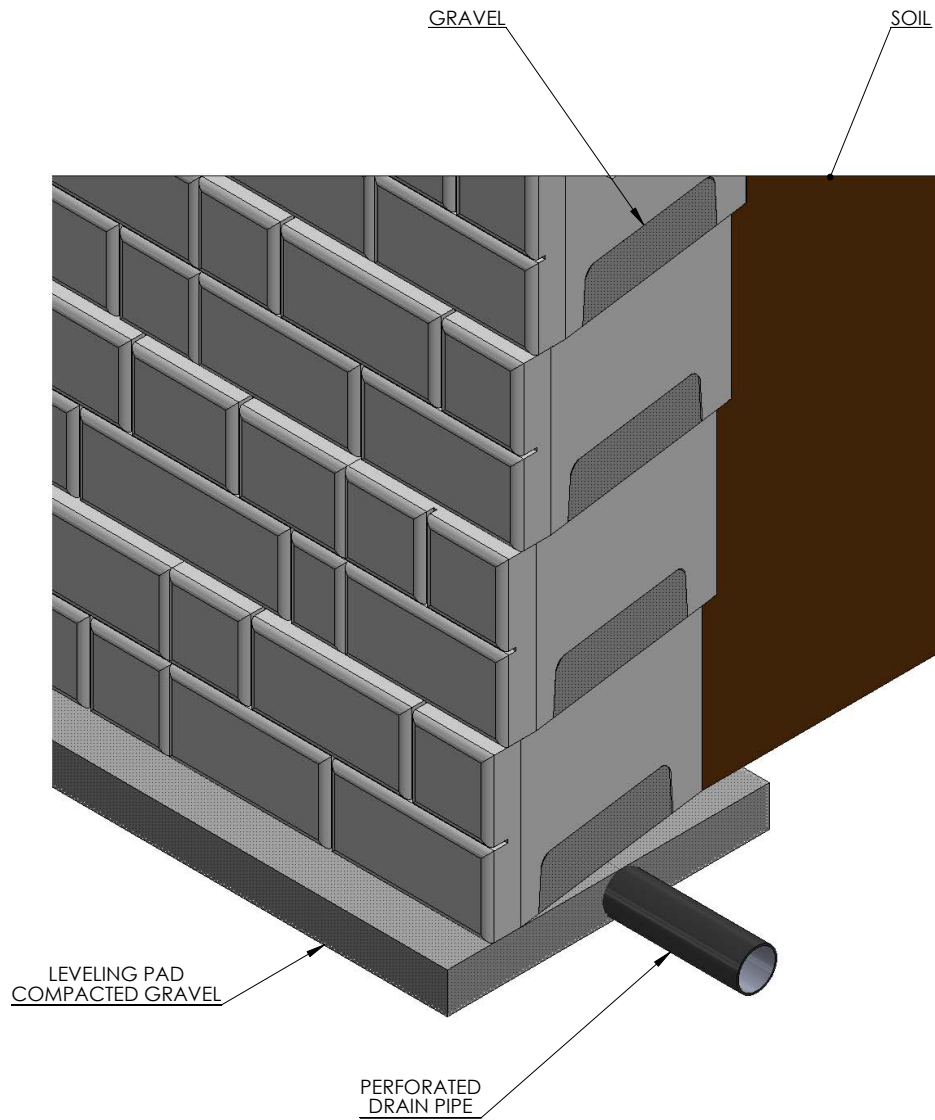

DRAIN PIPE IS PLACED INSIDE  
THE COMPACTED GRAVEL  
OF THE LEVELING PAD



DRAWN BY	DATE	TITLE:
DAN BALLING	12/12/2013	DRAIN PLACEMENT-OPTION #2
16500 SOUTH 500 WEST BLUFFDALE, UTAH 84065 PHONE: (801) 571-2028		DWG NO.
		WD-17
SCALE: 1: 20		SHEET 1 OF 1

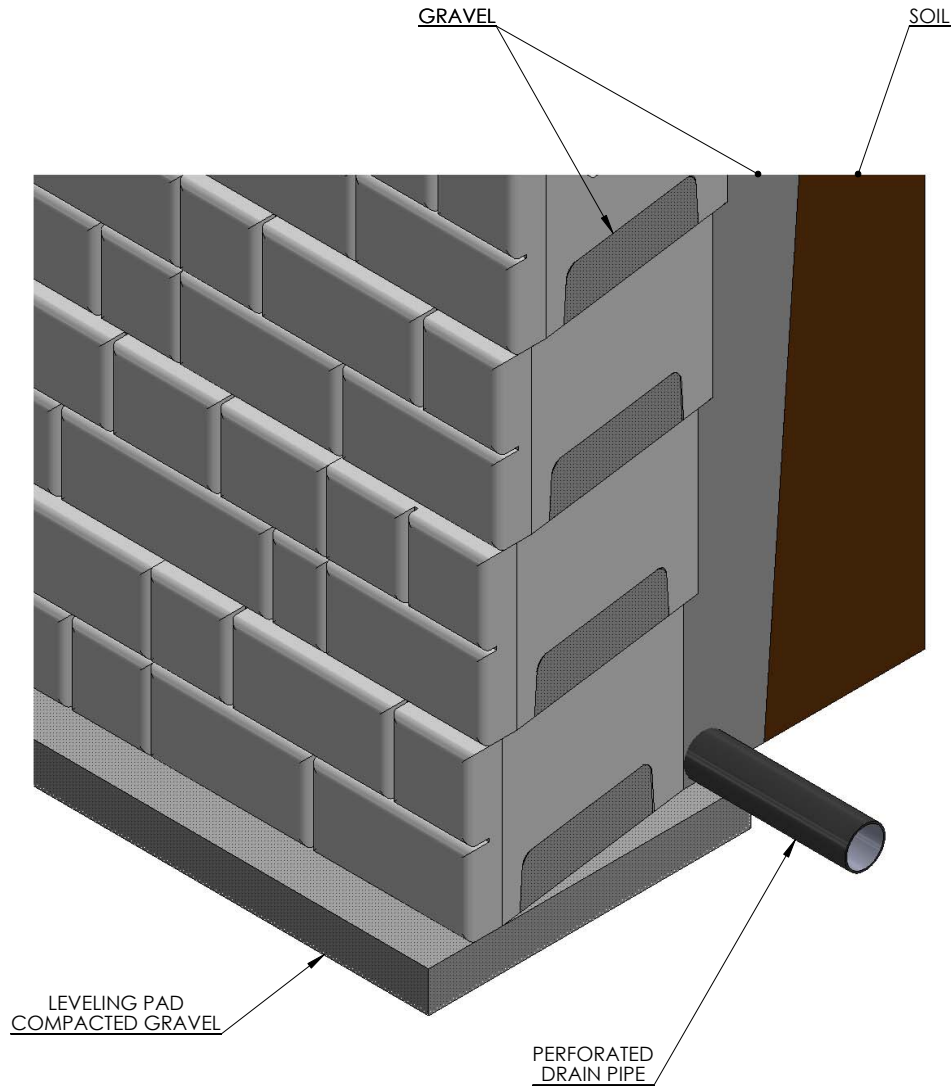

DRAIN PIPE IS PLACED BEHIND THE BLOCK AND ON TOP OF THE LEVELING PAD.  
THIS OPTION REQUIRES 1' OF LOOSE GRAVEL BEHIND THE WALL.  
IF DRAINAGE IS A MAJOR CONCERN FOR AN APPLICATION THIS OPTION  
MAY BE USED ALONG WITH OPTION 1 OR 2



DRAWN BY	DATE	TITLE:
DAN BALLING	12/18/2013	DRAIN PLACEMENT-OPTION #3
16500 SOUTH 500 WEST BLUFFDALE, UTAH 84065 PHONE: (801) 571-2028		DWG NO.
		WD-18
SCALE: 1: 20		SHEET 1 OF 1

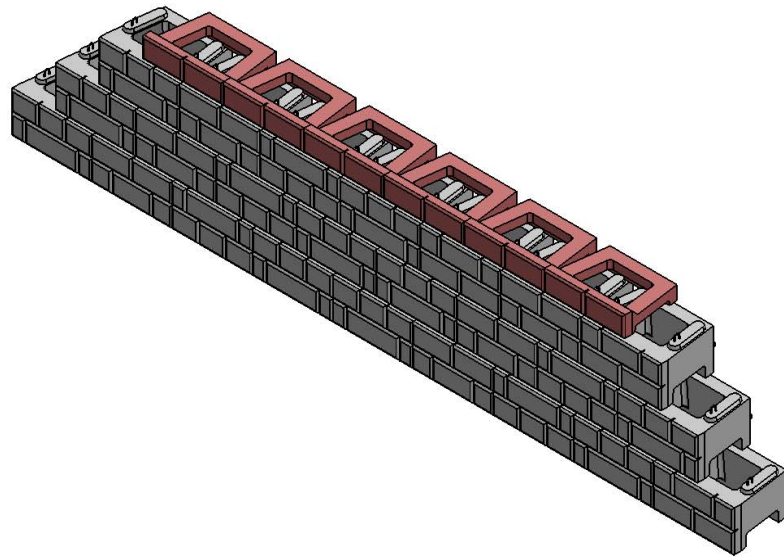

1 ROW OF HALF STEP BLOCKS

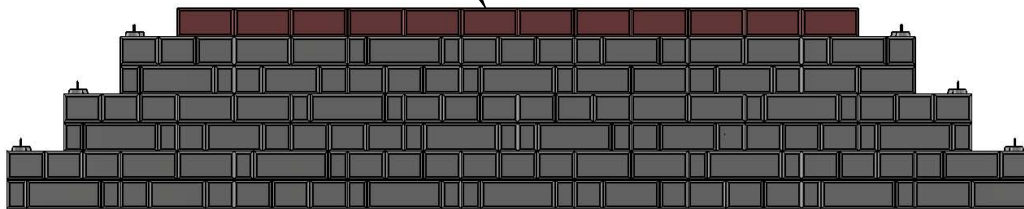
DRAWN BY	DATE	TITLE:
R FONTANESI	10/23/2015	HALF STEP TOP ROW
16500 SOUTH 500 WEST BLUFFDALE, UTAH 84065 PHONE: (801) 571-2028		DWG NO.
		WD-23
SCALE: 1: 30		SHEET 1 OF 1

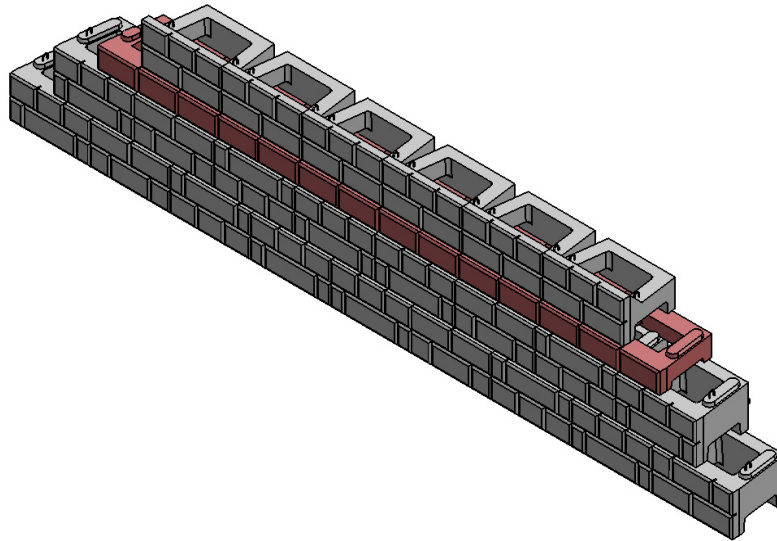

1 ROW OF HALF STEP BLOCKS

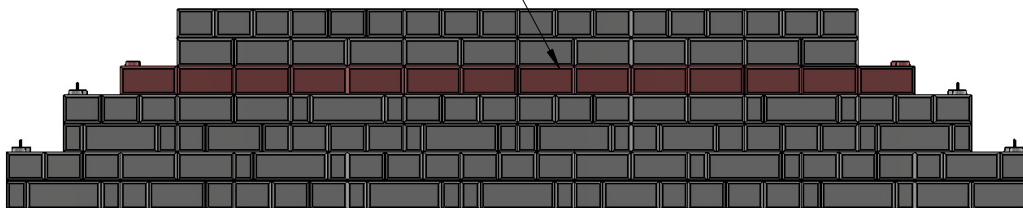

DRAWN BY	DATE	TITLE:
R FONTANESI	6/15/2015	HALF STEP 2ND ROW
16500 SOUTH 500 WEST BLUFFDALE, UTAH 84065 PHONE: (801) 571-2028		DWG NO.
		WD-24
SCALE: 1: 30		SHEET 1 OF 1

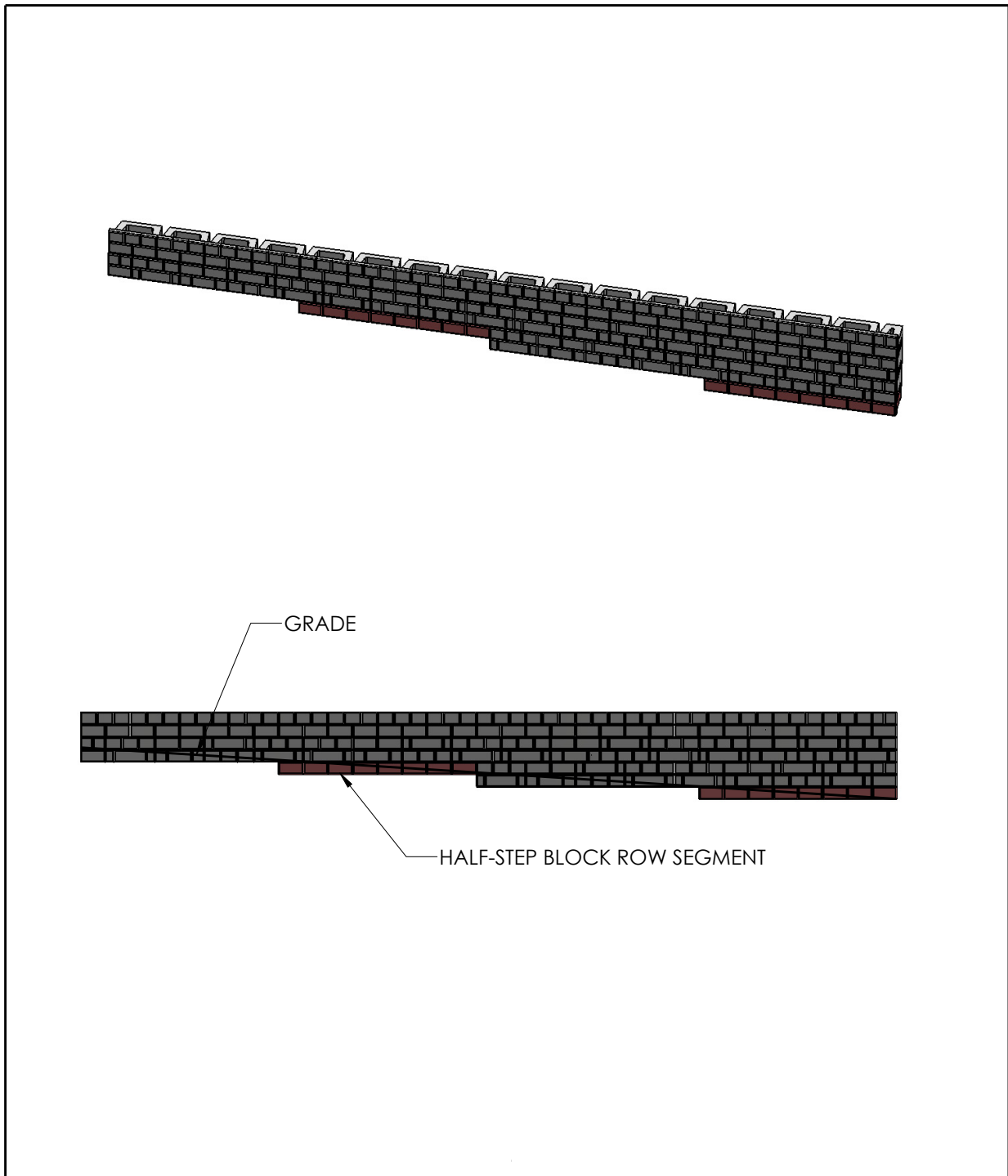

	DRAWN BY	DATE	TITLE:
	R FONTANESI	6/16/2015	BOTTOM ROW HALF STEP
	16500 SOUTH 500 WEST BLUFFDALE, UTAH 84065 PHONE: (801) 571-2028		DWG NO.
			WD-25
	SCALE: 1: 30		SHEET 1 OF 1