

STEP 1 - PLACE REINFORCEMENT SO THAT LITTLE OR NO OVERLAP OCCURS IN THE RADIUS AREA. IF OVERLAP OCCURS, PLACE 2 TO 3 INCHES OF SAND BETWEEN THE REINFORCEMENT LAYERS.

2 TO 3 INCHES OF SOIL FILL REQUIRED BETWEEN OVERLAPPED REINFORCEMENT FOR PROPER SOIL AND REINFORCEMENT INTERACTION.

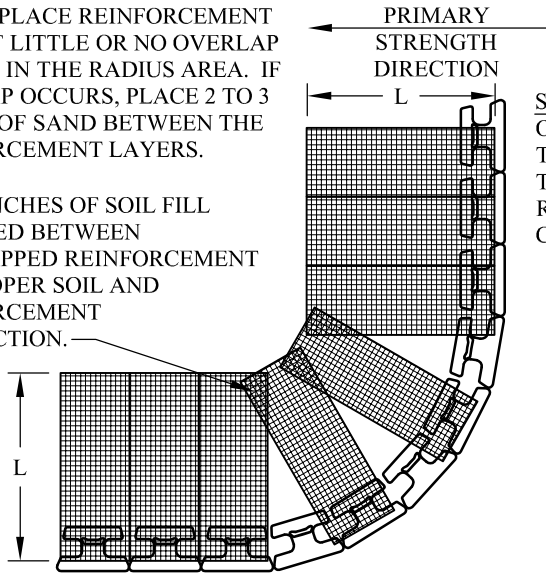

STEP 2 - LAY THE NEXT COURSE OF BLOCK. MAKE A MARK ON THE BACK OF THE BLOCKS IN THE AREAS THAT ARE NOT REINFORCED. BACKFILL AND COMPACT THAT COURSE.

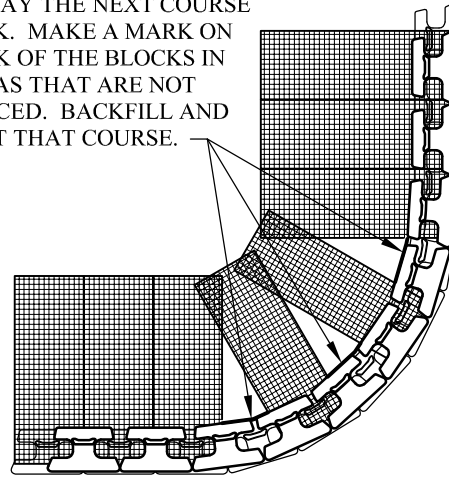

STEP 3 - PLACE REINFORCEMENT IN THE AREAS WHERE THE MARKS SHOW GAPS IN THE LOWER REINFORCEMENT PATTERN. CONTINUE NORMAL WALL CONSTRUCTION, REPEATING THESE STEPS AS NEEDED.

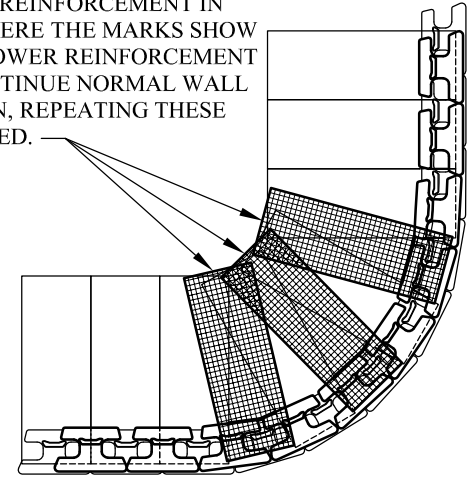

MINIMUM RADIUS
4.5 FEET TO BACK
OF TOP UNIT

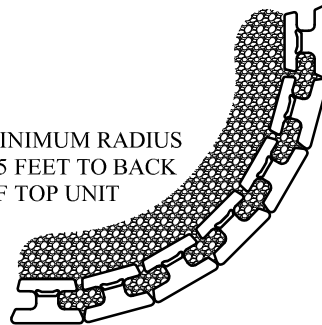

Anchor Wall Systems, Inc.
5959 Baker Road, Suite 390
Minnetonka, MN 55345

© 2014 Anchor Wall Systems, Inc.
® and ™ Anchor Wall Systems, Inc.

Drawn By:
AWE
Date:
10/30/2014
Scale:
1/4"=1'-0"

Drawing Title:
Vertica Stone Cut® Retaining Wall System
Outside Curve Details

Typical Details For
Segmental Retaining Walls