

CAST VENEER STONE BY EP HENRY  
Typical Installation Detail for Untreated Masonry,  
Concrete or Stucco

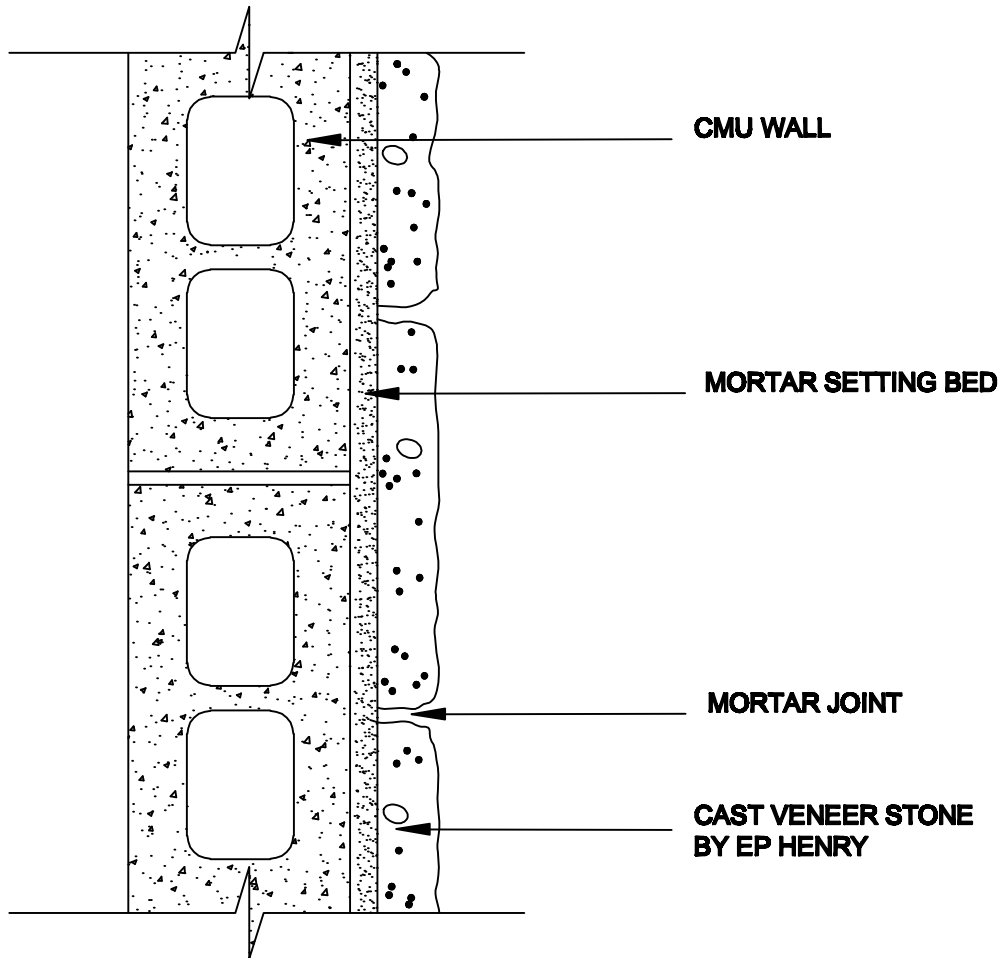

**NOTE: SUBSTRATE MUST BE CLEAN  
AND FREE FROM DIRT AND  
OTHER FOREIGN MATERIAL  
BEFORE INSTALLATION OF STONE**

UNTREATED MASONRY,  
CONCRETE OR STUCCO

**EP HENRY**  
FOUNDED 1903

**Call 1-800 44 Henry**

Ref. No.

201 Park Avenue, PO Box 615  
Woodbury, NJ 08096

**Figure 3**